



### Materiaux

| Composants             | 6SDX                        | 6SDXL                    | 8SDX                    | 8SDXL                   |
|------------------------|-----------------------------|--------------------------|-------------------------|-------------------------|
| Chemise extérieure     | Acier Cr-Ni AISI 304        | Acier Cr-Ni-Mo AISI 316L | Acier Cr-Ni AISI 304    | Acier Cr-Ni-Mo AISI 316 |
| Lanterne d'aspiration  |                             |                          |                         |                         |
| Couvercle supérieur    | Acier Cr-Ni-Mo AISI 316     |                          |                         |                         |
| Corps de refoulement   | Acier Cr-Ni-Mo AISI 316L    |                          | Acier Cr-Ni AISI 304    | Acier Cr-Ni-Mo AISI 316 |
| Panier                 | Acier Cr-Ni-Mo AISI 316     |                          |                         |                         |
| Clapet, ensemble       | NBR                         |                          |                         |                         |
| Joint de clapet        | NBR                         |                          |                         |                         |
| Arbre                  | Acier Cr-Ni-Mo AISI 316     |                          | Acier Cr-Ni-Mo AISI 329 |                         |
| Accouplement, ensemble | Acier Cr-Ni-Mo AISI 316/329 |                          |                         |                         |
| Diffuseur              | Acier Cr-Ni AISI 304        | Acier Cr-Ni-Mo AISI 316L | Acier Cr-Ni AISI 304    | Acier Cr-Ni-Mo AISI 316 |
| Corps d'étage          |                             |                          |                         |                         |
| Roue                   | Acier Cr-Ni AISI 304        | Acier Cr-Ni-Mo AISI 316L | Acier Cr-Ni-Mo AISI 316 |                         |
| Bague d'étanchéité     | Teflon (PTFE)               |                          |                         |                         |
| Coussinet              | NBR                         |                          |                         |                         |
| Profilé protégé-câble  | Acier Cr-Ni-Mo AISI 316     |                          |                         |                         |
| Vis                    | Acier Cr-Ni-Mo AISI 316     |                          |                         |                         |

### Moteur CS

| Composants          | CS 6", 8", 10" standard  | I-CS 6", 8", 10" AISI 316 |
|---------------------|--|---------------------------|
| Carcasse extérieure | AISI 304 (AISI 316Ti pour 10")   | Acier Cr-Ni-Mo AISI 316Ti |
| Supports            | Fonte GJL 200 EN 1561  | Acier Cr-Ni-Mo AISI 316   |
| Arbre               | Acier Cr AISI 420 Trempé et revenu<br>Acier Cr-Ni-Mo AISI 329 pour 10" | Acier Cr-Ni-Mo AISI 329   |
| Roulement           | Patins oscillants  | Patins oscillants         |
| Coussinet           | Graphite<br>(Bronze pour 8" de 51 - 59 - 66 kW)                        | Graphite                  |

### Exécution

Electropompes immergées pour puits de 6" (DN 150 mm) et 8" (DN 200 mm),

**6SDX, 8SDX:** avec chemise extérieure et étages en acier inox AISI 304

**6SDXL, 8SDXL:** avec chemise extérieure et étages en acier inox AISI 316.

### Roues

| Roues radiales   | Roues hélicocentrifuges         |
|------------------|---------------------------------|
| 6SDX(L) 13-18-27 | 6SDX(L) 30-46-65, 8SDX(L) 78-97 |

**Orifice:** Orifice fileté ISO 228

Clapet de retenue incorporé dans le corps de refoulement.

### Utilisation

Pour l'approvisionnement en eau.

Pour applications civiles et industrielles.

Pour services incendie.

Pour irrigation.

### Limites d'utilisation

Température de l'eau jusqu'à 25 °C.

Max quantité de sable dans l'eau: 100 g/m<sup>3</sup>.

Service continu.

### Moteur rebobinable série CS 6", 8", 10"

Moteur à induction à 2 pôles, 50 Hz (n = 2900 1/min).

Bobinage en bain d'eau rebobinable.

Dimensions pour connexion à la pompe selon NEMA Standards.

Alimentation électrique:

- triphasée 400 V; 400/690 V.

Variation de voltage : +6% / -10%

Type de démarrage conseillé pour puissances à partir du 7.5kW: étoile/triangle, soft start, à impédance, auto-transformateur.

| Moteur | Température de l'eau jusqu'à | Refroidissement: vitesse mini du flux                 | Démarrage heure maxi |
|--------|------------------------------|---|----------------------|
| 4"     | 35 °C                        | 0,08 m/s  | 20                   |
| 6"     | 25 °C                        | 0,20 m/s para 4 ÷ 15 kW<br>0,50 m/s para 18,5 ÷ 30 kW | 15                   |
| 8"     | 25 °C                        | 0,20 m/s para 30 ÷ 51 kW<br>0,50 m/s para 55 ÷ 75 kW  | 15                   |
| 10"    | 25 °C                        | 0,50 m/s  | 10                   |

Isolation fil avec revêtement en PVC pour moteurs 6-8-10".  
Protection IP 68.

### Câble

| Moteur 400V - 50Hz - 3 ~ | Section                       | Longueur |
|--------------------------|-------------------------------|----------|
| 4CS 2,2 ÷ 3 kW           | 3x1,5 + 1G1,5 mm <sup>2</sup> | 3 m      |
| 6CS 4 ÷ 30 kW            | 4G6 mm <sup>2</sup>           | 3,5 m    |
| 8CS 30 ÷ 59 kW           | 3 x (1x16) mm <sup>2</sup>    | 4 m      |
| 8CS 66 - 92 kW           | 3 x (1x25) mm <sup>2</sup>    | 4 m      |
| 10CS 85-130 kW           | 3 x 50 mm <sup>2</sup>        | 6 m      |

### Exécutions spéciales sur demande

- Autres tensions.
- Fréquence 60 Hz.
- Autres températures.
- Moteur série FK.
- Moteur préparé pour fonctionnement avec variateur de fréquence (exécution standard pour FK).

### Identification

Ø du puits en pouces \_\_\_\_\_

Série \_\_\_\_\_

Construction en Acier Cr-Ni-Mo AISI 316 \_\_\_\_\_

Identification de l'étage \_\_\_\_\_

Nombre des étages \_\_\_\_\_

6 SDX L 13 / 17

**Graphique d'utilisation n ≈ 2900 1/min**

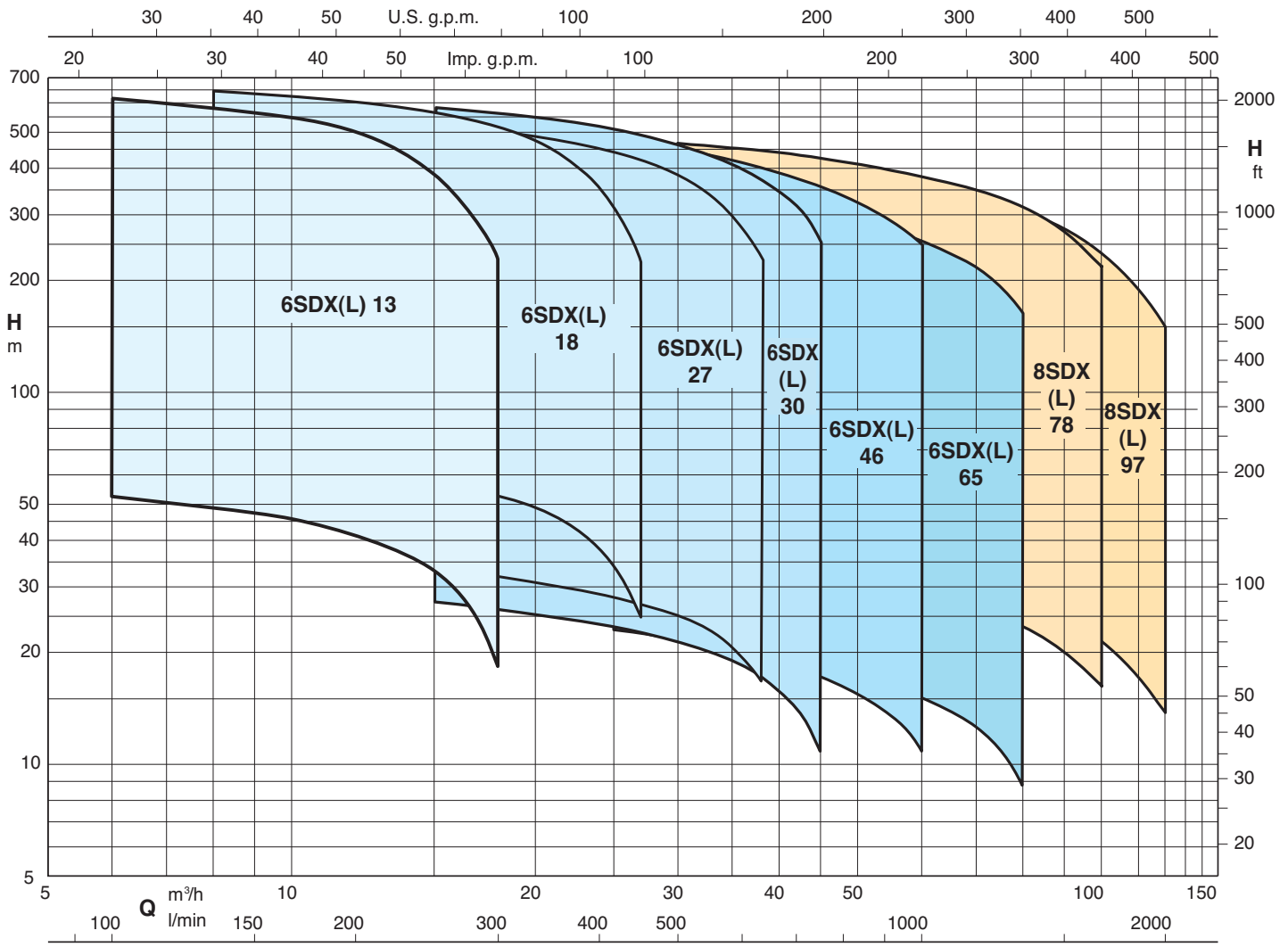

# 6SDX 13

Pompes immergées pour puits de 6"



## Courbes caractéristiques

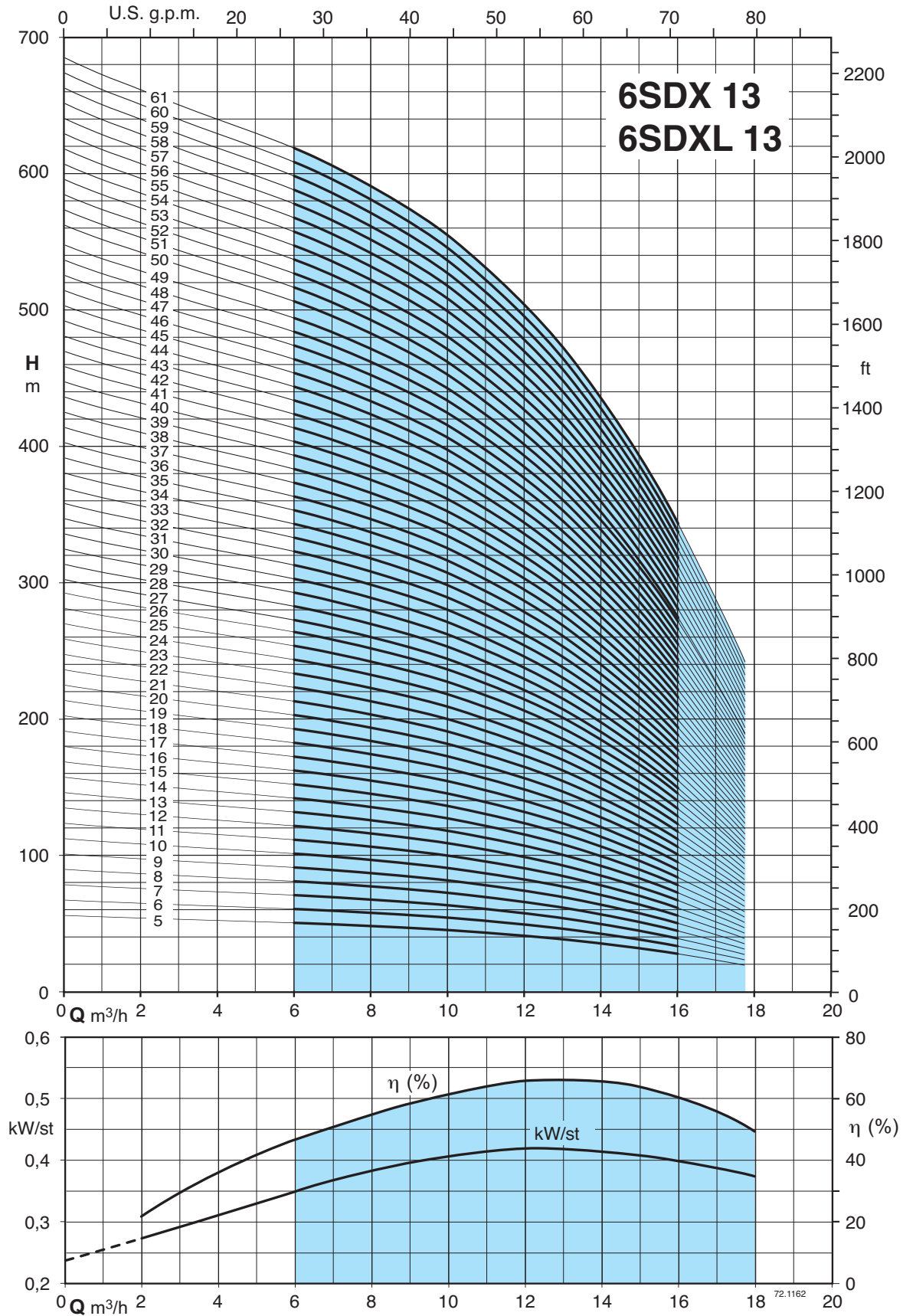

# 6SDX 13

Pompes immergées pour puits de 6"



## Performances n ≈ 2900 1/min, dimensions et poids

| 3 ~            | P <sub>2</sub> |           | Q<br>m <sup>3</sup> /h<br>l/min | n ≈ 2900 1/min |      |      |      |      |      |      |   |   |  | DN | Motore   |          | L<br>mm | kg   |
|----------------|----------------|-----------|---------------------------------|----------------|------|------|------|------|------|------|---|---|--|----|----------|----------|---------|------|
|                | kW             | HP        |                                 | H m            |      |      |      |      |      |      |   |   |  |    | CS<br>mm | FK<br>mm |         |      |
|                |                |           |                                 | 0              | 6    | 8    | 10   | 12   | 15   | 18   | - | - |  |    |          |          |         |      |
| 6SDX (L) 13/5  | 2,2            | 3         |                                 | 56,1           | 50,7 | 48,4 | 45,4 | 41,4 | 31,3 | 18,6 | - | - |  |    | 96       | 95,5     | 414     | 11,5 |
| 6SDX (L) 13/6  | 3              | 4         |                                 | 67,3           | 60,8 | 58,1 | 54,5 | 49,7 | 37,5 | 22,3 |   |   |  |    | 4"       | 4"       | 444     | 12,3 |
| 6SDX (L) 13/7  | 3              | 4         |                                 | 78,5           | 71,0 | 67,8 | 63,6 | 58,0 | 43,8 | 26,0 |   |   |  |    |          |          | 474     | 13   |
| 6SDX (L) 13/8  | 4              | 5,5       |                                 | 89,7           | 81,1 | 77,5 | 72,7 | 66,3 | 50,0 | 29,7 |   |   |  |    |          |          | 501     | 14   |
| 6SDX (L) 13/9  | 5,5            | 7,5       |                                 | 101            | 91,2 | 87,2 | 81,8 | 74,6 | 56,3 | 33,4 |   |   |  |    |          |          | 531     | 14,5 |
| 6SDX (L) 13/10 | 5,5            | 7,5       |                                 | 112            | 101  | 96,9 | 90,9 | 82,9 | 62,5 | 37,1 |   |   |  |    |          |          | 561     | 15   |
| 6SDX (L) 13/11 | 5,5            | 7,5       |                                 | 123            | 112  | 107  | 100  | 91,2 | 68,8 | 40,8 |   |   |  |    |          |          | 591     | 16   |
| 6SDX (L) 13/12 | 5,5            | 7,5       |                                 | 135            | 122  | 116  | 109  | 99,5 | 75,0 | 44,6 |   |   |  |    |          |          | 621     | 16,8 |
| 6SDX (L) 13/13 | 5,5            | 7,5       |                                 | 146            | 132  | 126  | 118  | 108  | 81,3 | 48,3 |   |   |  |    |          |          | 651     | 17,5 |
| 6SDX (L) 13/14 | 7,5            | 10        |                                 | 157            | 142  | 136  | 127  | 116  | 87,5 | 52,0 |   |   |  |    |          |          | 681     | 18,5 |
| 6SDX (L) 13/15 | 7,5            | 10        |                                 | 168            | 152  | 145  | 136  | 124  | 93,8 | 55,7 |   |   |  |    |          |          | 711     | 19   |
| 6SDX (L) 13/16 | 7,5            | 10        |                                 | 179            | 162  | 155  | 145  | 133  | 100  | 59,4 |   |   |  |    |          |          | 741     | 19,8 |
| 6SDX (L) 13/17 | 7,5            | 10        |                                 | 191            | 172  | 165  | 155  | 141  | 106  | 63,1 |   |   |  |    |          |          | 771     | 20,5 |
| 6SDX (L) 13/18 | 9,2            | 12,5      |                                 | 202            | 183  | 174  | 164  | 149  | 113  | 66,8 |   |   |  |    |          |          | 801     | 21,3 |
| 6SDX (L) 13/19 | 9,2            | 12,5      |                                 | 213            | 193  | 184  | 173  | 158  | 119  | 70,5 |   |   |  |    |          |          | 831     | 22   |
| 6SDX (L) 13/20 | 9,2            | 12,5      |                                 | 224            | 203  | 194  | 182  | 166  | 125  | 74,3 |   |   |  |    |          |          | 861     | 23   |
| 6SDX (L) 13/21 | 9,2            | 12,5      |                                 | 236            | 213  | 203  | 191  | 174  | 131  | 78,0 |   |   |  |    |          |          | 891     | 23,5 |
| 6SDX (L) 13/22 | 9,2            | 12,5      |                                 | 247            | 223  | 213  | 200  | 182  | 138  | 81,7 |   |   |  |    |          |          | 921     | 24   |
| 6SDX (L) 13/23 | 11             | 15        |                                 | 258            | 233  | 223  | 209  | 191  | 144  | 85,4 |   |   |  |    |          |          | 951     | 25   |
| 6SDX (L) 13/24 | 11             | 15        |                                 | 269            | 243  | 233  | 218  | 199  | 150  | 89,1 |   |   |  |    |          |          | 981     | 25,5 |
| 6SDX (L) 13/25 | 11             | 15        |                                 | 280            | 253  | 242  | 227  | 207  | 156  | 92,8 |   |   |  |    |          |          | 1011    | 26,5 |
| 6SDX (L) 13/26 | 11             | 15        |                                 | 292            | 264  | 252  | 236  | 216  | 163  | 96,5 |   |   |  |    |          |          | 1041    | 27   |
| 6SDX (L) 13/27 | 13 (15)        | 17,5 (20) |                                 | 303            | 274  | 262  | 245  | 224  | 169  | 100  |   |   |  |    |          |          | 1071    | 29   |
| 6SDX (L) 13/28 | 13 (15)        | 17,5 (20) |                                 | 314            | 284  | 271  | 255  | 232  | 175  | 104  |   |   |  |    |          |          | 1101    | 29   |
| 6SDX (L) 13/29 | 13 (15)        | 17,5 (20) |                                 | 325            | 294  | 281  | 264  | 240  | 181  | 108  |   |   |  |    |          |          | 1131    | 30,5 |
| 6SDX (L) 13/30 | 13 (15)        | 17,5 (20) |                                 | 336            | 304  | 291  | 273  | 249  | 188  | 111  |   |   |  |    |          |          | 1161    | 30,8 |
| 6SDX (L) 13/31 | 13 (15)        | 17,5 (20) |                                 | 348            | 314  | 300  | 282  | 257  | 194  | 115  |   |   |  |    |          |          | 1191    | 31   |
| 6SDX (L) 13/32 | 15             | 20        |                                 | 359            | 324  | 310  | 291  | 265  | 200  | 119  |   |   |  |    |          |          | 1221    | 31,5 |
| 6SDX (L) 13/33 | 15             | 20        |                                 | 370            | 335  | 320  | 300  | 274  | 206  | 123  |   |   |  |    |          |          | 1251    | 32,5 |
| 6SDX (L) 13/34 | 15             | 20        |                                 | 381            | 345  | 329  | 309  | 282  | 213  | 126  |   |   |  |    |          |          | 1281    | 33,5 |
| 6SDX (L) 13/35 | 15             | 20        |                                 | 392            | 355  | 339  | 318  | 290  | 219  | 130  |   |   |  |    |          |          | 1311    | 34   |
| 6SDX (L) 13/36 | 15             | 20        |                                 | 404            | 365  | 349  | 327  | 298  | 225  | 134  |   |   |  |    |          |          | 1341    | 34,5 |
| 6SDX (L) 13/37 | 18,5           | 25        |                                 | 415            | 375  | 358  | 336  | 307  | 231  | 137  |   |   |  |    |          |          | 1371    | 35,3 |
| 6SDX (L) 13/38 | 18,5           | 25        |                                 | 426            | 385  | 368  | 345  | 315  | 238  | 141  |   |   |  |    |          |          | 1401    | 36   |
| 6SDX (L) 13/39 | 18,5           | 25        |                                 | 437            | 395  | 378  | 354  | 323  | 244  | 145  |   |   |  |    |          |          | 1431    | 37,3 |
| 6SDX (L) 13/40 | 18,5           | 25        |                                 | 449            | 406  | 388  | 364  | 332  | 250  | 149  |   |   |  |    |          |          | 1461    | 38,5 |
| 6SDX (L) 13/41 | 18,5           | 25        |                                 | 460            | 416  | 397  | 373  | 340  | 256  | 152  |   |   |  |    |          |          | 1491    | 38,8 |
| 6SDX (L) 13/42 | 18,5           | 25        |                                 | 471            | 426  | 407  | 382  | 348  | 263  | 156  |   |   |  |    |          |          | 1521    | 39   |
| 6SDX (L) 13/43 | 18,5           | 25        |                                 | 482            | 436  | 417  | 391  | 356  | 269  | 160  |   |   |  |    |          |          | 1551    | 39,8 |
| 6SDX (L) 13/44 | 18,5           | 25        |                                 | 493            | 446  | 426  | 400  | 365  | 275  | 163  |   |   |  |    |          |          | 1581    | 40,5 |
| 6SDX (L) 13/45 | 22             | 30        |                                 | 505            | 456  | 436  | 409  | 373  | 281  | 167  |   |   |  |    |          |          | 1611    | 41,3 |
| 6SDX (L) 13/46 | 22             | 30        |                                 | 516            | 466  | 446  | 418  | 381  | 288  | 171  |   |   |  |    |          |          | 1641    | 42   |
| 6SDX (L) 13/47 | 22             | 30        |                                 | 527            | 477  | 455  | 427  | 390  | 294  | 175  |   |   |  |    |          |          | 1671    | 43   |
| 6SDX (L) 13/48 | 22             | 30        |                                 | 538            | 487  | 465  | 436  | 398  | 300  | 178  |   |   |  |    |          |          | 1700    | 44   |
| 6SDX (L) 13/49 | 22             | 30        |                                 | 549            | 497  | 475  | 445  | 406  | 306  | 182  |   |   |  |    |          |          | 1731    | 45   |
| 6SDX (L) 13/50 | 22             | 30        |                                 | 561            | 507  | 484  | 454  | 414  | 313  | 186  |   |   |  |    |          |          | 1761    | 46   |
| 6SDX (L) 13/51 | 22             | 30        |                                 | 572            | 517  | 494  | 464  | 423  | 319  | 189  |   |   |  |    |          |          | 1791    | 47   |
| 6SDX (L) 13/52 | 22             | 30        |                                 | 583            | 527  | 504  | 473  | 431  | 325  | 193  |   |   |  |    |          |          | 1821    | 48   |
| 6SDX (L) 13/53 | 26 (30)        | 35 (40)   |                                 | 594            | 537  | 513  | 482  | 439  | 331  | 197  |   |   |  |    |          |          | 1851    | 48,8 |
| 6SDX (L) 13/54 | 26 (30)        | 35 (40)   |                                 | 606            | 547  | 523  | 491  | 448  | 338  | 201  |   |   |  |    |          |          | 1881    | 49,7 |
| 6SDX (L) 13/55 | 26 (30)        | 35 (40)   |                                 | 617            | 558  | 533  | 500  | 456  | 344  | 204  |   |   |  |    |          |          | 1911    | 50,5 |
| 6SDX (L) 13/56 | 26 (30)        | 35 (40)   |                                 | 628            | 568  | 543  | 509  | 464  | 350  | 208  |   |   |  |    |          |          | 1941    | 51,3 |
| 6SDX (L) 13/57 | 26 (30)        | 35 (40)   |                                 | 639            | 578  | 552  | 518  | 472  | 356  | 212  |   |   |  |    |          |          | 1971    | 52,2 |
| 6SDX (L) 13/58 | 26 (30)        | 35 (40)   |                                 | 650            | 588  | 562  | 527  | 481  | 363  | 215  |   |   |  |    |          |          | 2000    | 53   |
| 6SDX (L) 13/59 | 26 (30)        | 35 (40)   |                                 | 662            | 598  | 572  | 536  | 489  | 369  | 219  |   |   |  |    |          |          | 2030    | 54   |
| 6SDX (L) 13/60 | 26 (30)        | 35 (40)   |                                 | 673            | 608  | 581  | 545  | 497  | 375  | 223  |   |   |  |    |          |          | 2060    | 55   |
| 6SDX (L) 13/61 | 26 (30)        | 35 (40)   |                                 | 684            | 618  | 591  | 554  | 506  | 381  | 227  |   |   |  |    |          |          | 2090    | 56   |

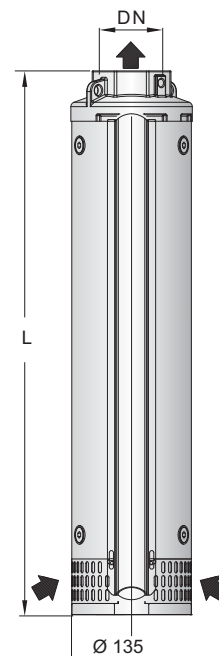

4", 6"

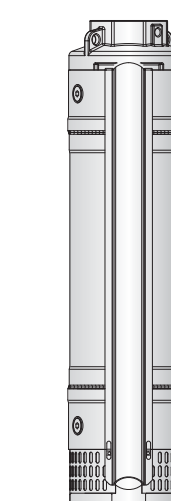
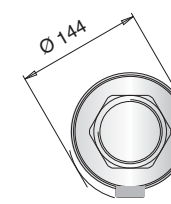
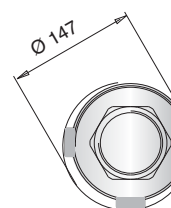

Collier spécial de renforcement à partir 6SDX(L) 13/50

# 6SDX 18

Pompes immergées pour puits de 6"



## Courbes caractéristiques

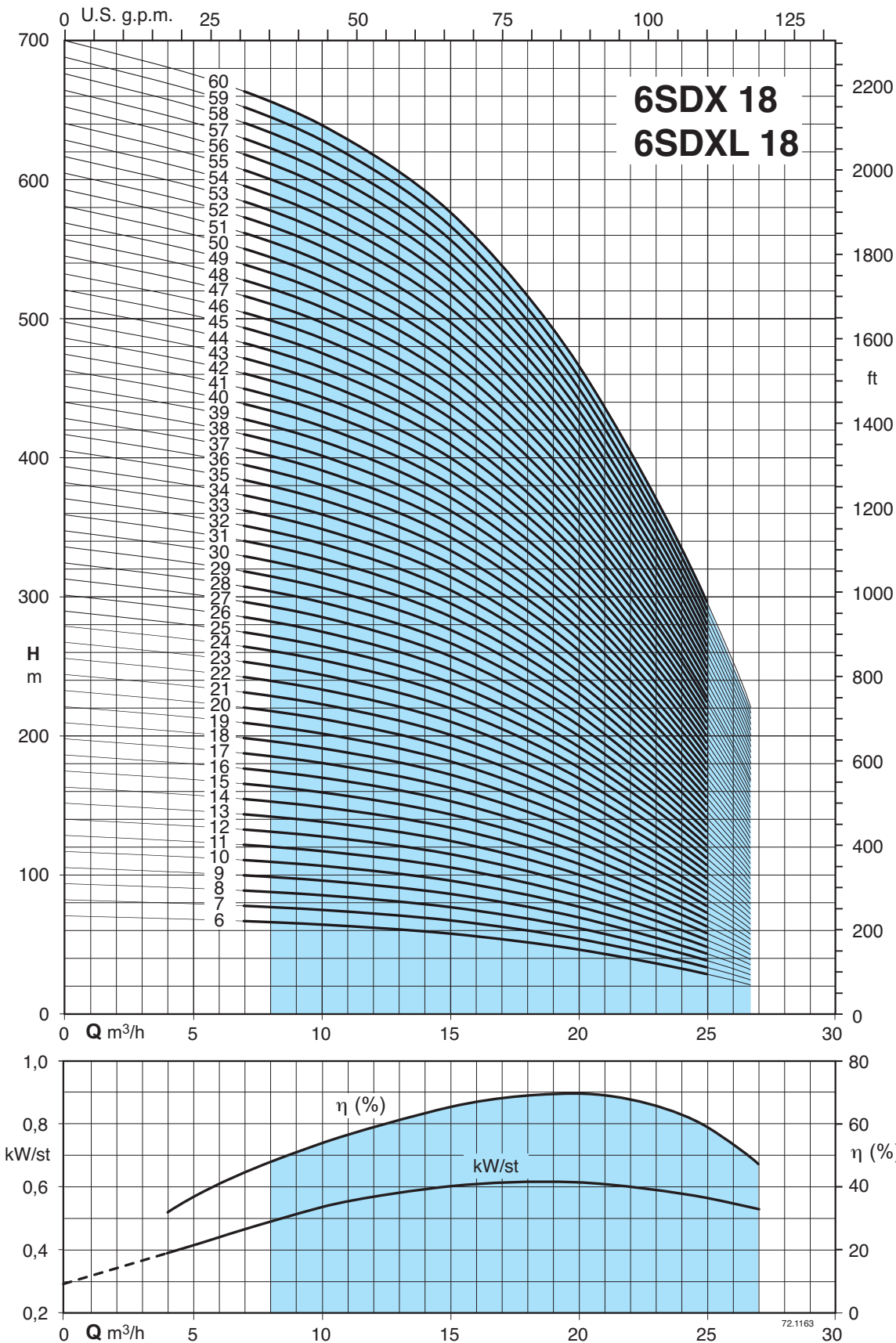



# 6SDX 18

Pompes immergées pour puits de 6"



## Performances n ≈ 2900 1/min, dimensions et poids

| 3 ~            | P <sub>2</sub> |           | Q     | n ≈ 2900 rpm      |      |      |      |      |      |      |      |        |           | DN          | Motore    |      | L    | kg |
|----------------|----------------|-----------|-------|-------------------|------|------|------|------|------|------|------|--------|-----------|-------------|-----------|------|------|----|
|                | kW             | HP        |       | m <sup>3</sup> /h |      |      |      |      |      |      |      |        |           |             | CS        | FK   |      |    |
|                |                |           | l/min | 0                 | 8    | 10   | 12   | 15   | 18   | 21   | 24   | 27     | mm        |             |           |      |      |    |
| 6SDX (L) 18/6  | 4              | 5,5       | 70    | 66,4              | 64   | 62   | 57,6 | 51,6 | 43,2 | 32,9 | 20,5 | H<br>m | 145<br>6" | Rp<br>2"1/2 | 137<br>6" | 494  | 12,5 |    |
| 6SDX (L) 18/7  | 5,5            | 7,5       | 81,7  | 77,5              | 74,7 | 72,3 | 67,2 | 60,2 | 50,4 | 38,4 | 23,9 |        |           |             |           | 532  | 13,5 |    |
| 6SDX (L) 18/8  | 5,5            | 7,5       | 93,3  | 88,5              | 85,3 | 82,7 | 76,8 | 68,8 | 57,6 | 43,9 | 27,4 |        |           |             |           | 569  | 14,3 |    |
| 6SDX (L) 18/9  | 5,5            | 7,5       | 105   | 99,6              | 96   | 93   | 86,4 | 77,4 | 64,8 | 49,4 | 30,8 |        |           |             |           | 607  | 15   |    |
| 6SDX (L) 18/10 | 7,5            | 10        | 117   | 111               | 107  | 103  | 96   | 86   | 72,0 | 54,9 | 34,2 |        |           |             |           | 644  | 16   |    |
| 6SDX (L) 18/11 | 7,5            | 10        | 128   | 122               | 117  | 114  | 106  | 94,6 | 79,2 | 60,4 | 37,6 |        |           |             |           | 682  | 17   |    |
| 6SDX (L) 18/12 | 7,5            | 10        | 140   | 133               | 128  | 124  | 115  | 103  | 86,4 | 65,8 | 41,0 |        |           |             |           | 719  | 17,5 |    |
| 6SDX (L) 18/13 | 9,2            | 12,5      | 152   | 144               | 139  | 134  | 125  | 112  | 93,6 | 71,3 | 44,5 |        |           |             |           | 757  | 18,5 |    |
| 6SDX (L) 18/14 | 9,2            | 12,5      | 163   | 155               | 149  | 145  | 134  | 120  | 101  | 76,8 | 47,9 |        |           |             |           | 794  | 19,3 |    |
| 6SDX (L) 18/15 | 9,2            | 12,5      | 175   | 166               | 160  | 155  | 144  | 129  | 108  | 82,3 | 51,3 |        |           |             |           | 832  | 20   |    |
| 6SDX (L) 18/16 | 11             | 15        | 187   | 177               | 171  | 165  | 154  | 138  | 115  | 87,8 | 54,7 |        |           |             |           | 869  | 21   |    |
| 6SDX (L) 18/17 | 11             | 15        | 198   | 188               | 181  | 176  | 163  | 146  | 122  | 93,3 | 58,1 |        |           |             |           | 907  | 22   |    |
| 6SDX (L) 18/18 | 11             | 15        | 210   | 199               | 192  | 186  | 173  | 155  | 130  | 98,8 | 61,6 |        |           |             |           | 944  | 22,5 |    |
| 6SDX (L) 18/19 | 13 (15)        | 17,5 (20) | 222   | 210               | 203  | 196  | 182  | 163  | 137  | 104  | 65,0 |        |           |             |           | 982  | 23,5 |    |
| 6SDX (L) 18/20 | 13 (15)        | 17,5 (20) | 233   | 221               | 213  | 207  | 192  | 172  | 144  | 110  | 68,4 |        |           |             |           | 1019 | 24   |    |
| 6SDX (L) 18/21 | 13 (15)        | 17,5 (20) | 245   | 232               | 224  | 217  | 202  | 181  | 151  | 115  | 71,8 |        |           |             |           | 1057 | 25   |    |
| 6SDX (L) 18/22 | 15             | 20        | 257   | 243               | 235  | 227  | 211  | 189  | 158  | 121  | 75,2 |        |           |             |           | 1094 | 26   |    |
| 6SDX (L) 18/23 | 15             | 20        | 268   | 254               | 245  | 238  | 221  | 198  | 166  | 126  | 78,7 |        |           |             |           | 1132 | 26,5 |    |
| 6SDX (L) 18/24 | 15             | 20        | 280   | 266               | 256  | 248  | 230  | 206  | 173  | 132  | 82,1 |        |           |             |           | 1169 | 27,5 |    |
| 6SDX (L) 18/25 | 18,5           | 25        | 292   | 277               | 267  | 258  | 240  | 215  | 180  | 137  | 85,5 |        |           |             |           | 1207 | 28,3 |    |
| 6SDX (L) 18/26 | 18,5           | 25        | 303   | 288               | 277  | 269  | 250  | 224  | 187  | 143  | 88,9 |        |           |             |           | 1244 | 29   |    |
| 6SDX (L) 18/27 | 18,5           | 25        | 315   | 299               | 288  | 279  | 259  | 232  | 194  | 148  | 92,3 |        |           |             |           | 1282 | 31   |    |
| 6SDX (L) 18/28 | 18,5           | 25        | 327   | 310               | 299  | 289  | 269  | 241  | 202  | 154  | 95,8 |        |           |             |           | 1319 | 31   |    |
| 6SDX (L) 18/29 | 18,5           | 25        | 338   | 321               | 309  | 300  | 278  | 249  | 209  | 159  | 99,2 |        |           |             |           | 1356 | 31,5 |    |
| 6SDX (L) 18/30 | 18,5           | 25        | 350   | 332               | 320  | 310  | 288  | 258  | 216  | 165  | 103  |        |           |             |           | 1394 | 32,5 |    |
| 6SDX (L) 18/31 | 22             | 30        | 362   | 343               | 331  | 320  | 298  | 267  | 223  | 170  | 106  |        |           |             |           | 1431 | 33,3 |    |
| 6SDX (L) 18/32 | 22             | 30        | 373   | 354               | 342  | 331  | 307  | 275  | 230  | 176  | 109  |        |           |             |           | 1469 | 34   |    |
| 6SDX (L) 18/33 | 22             | 30        | 385   | 365               | 352  | 341  | 317  | 284  | 238  | 181  | 113  |        |           |             |           | 1506 | 35   |    |
| 6SDX (L) 18/34 | 22             | 30        | 397   | 376               | 363  | 351  | 326  | 292  | 245  | 187  | 116  |        |           |             |           | 1544 | 35,7 |    |
| 6SDX (L) 18/35 | 22             | 30        | 408   | 387               | 373  | 362  | 336  | 301  | 252  | 192  | 120  |        |           |             |           | 1581 | 36,3 |    |
| 6SDX (L) 18/36 | 22             | 30        | 420   | 398               | 384  | 372  | 346  | 310  | 259  | 198  | 123  |        |           |             |           | 1619 | 37   |    |
| 6SDX (L) 18/37 | 26 (30)        | 35 (40)   | 432   | 409               | 395  | 382  | 355  | 318  | 266  | 203  | 127  |        |           |             |           | 1656 | 38,4 |    |
| 6SDX (L) 18/38 | 26 (30)        | 35 (40)   | 443   | 420               | 405  | 393  | 365  | 327  | 274  | 209  | 130  |        |           |             |           | 1694 | 39,8 |    |
| 6SDX (L) 18/39 | 26 (30)        | 35 (40)   | 455   | 432               | 416  | 403  | 374  | 335  | 281  | 214  | 133  |        |           |             |           | 1731 | 40   |    |
| 6SDX (L) 18/40 | 26 (30)        | 35 (40)   | 467   | 443               | 427  | 413  | 384  | 344  | 288  | 220  | 137  |        |           |             |           | 1769 | 40,5 |    |
| 6SDX (L) 18/41 | 26 (30)        | 35 (40)   | 478   | 454               | 437  | 424  | 394  | 353  | 295  | 225  | 140  |        |           |             |           | 1806 | 41,8 |    |
| 6SDX (L) 18/42 | 26 (30)        | 35 (40)   | 490   | 465               | 448  | 434  | 403  | 361  | 302  | 230  | 144  |        |           |             |           | 1844 | 43   |    |
| 6SDX (L) 18/43 | 30             | 40        | 502   | 476               | 459  | 444  | 413  | 370  | 310  | 236  | 147  |        |           |             |           | 1881 | 44   |    |
| 6SDX (L) 18/44 | 30             | 40        | 513   | 487               | 469  | 455  | 422  | 378  | 317  | 241  | 151  |        |           |             |           | 1919 | 45   |    |
| 6SDX (L) 18/45 | 30             | 40        | 525   | 498               | 480  | 465  | 432  | 387  | 324  | 247  | 154  |        |           |             |           | 1956 | 46   |    |
| 6SDX (L) 18/46 | 30             | 40        | 537   | 509               | 491  | 475  | 442  | 396  | 331  | 252  | 157  |        |           |             |           | 1993 | 47   |    |
| 6SDX (L) 18/47 | 30             | 40        | 548   | 520               | 501  | 486  | 451  | 404  | 338  | 258  | 161  |        |           |             |           | 2031 | 47,5 |    |
| 6SDX (L) 18/48 | 30             | 40        | 560   | 531               | 512  | 496  | 461  | 413  | 346  | 263  | 164  |        |           |             |           | 2068 | 48   |    |
| 6SDX (L) 18/49 | 30             | 40        | 572   | 542               | 523  | 506  | 470  | 421  | 353  | 269  | 168  |        |           |             |           | 2106 | 50   |    |
| 6SDX (L) 18/50 | (37)           | (50)      | 583   | 553               | 533  | 517  | 480  | 430  | 360  | 274  | 171  |        |           |             |           | 2143 | 51   |    |
| 6SDX (L) 18/51 | (37)           | (50)      | 595   | 564               | 544  | 527  | 490  | 439  | 367  | 280  | 174  |        |           |             |           | 2181 | 52   |    |
| 6SDX (L) 18/52 | (37)           | (50)      | 607   | 575               | 555  | 537  | 499  | 447  | 374  | 285  | 178  |        |           |             |           | 2218 | 53   |    |
| 6SDX (L) 18/53 | (37)           | (50)      | 618   | 586               | 565  | 548  | 509  | 456  | 382  | 291  | 181  |        |           |             |           | 2256 | 54   |    |
| 6SDX (L) 18/54 | (37)           | (50)      | 630   | 598               | 576  | 558  | 518  | 464  | 389  | 296  | 185  |        |           |             |           | 2293 | 55   |    |
| 6SDX (L) 18/55 | (37)           | (50)      | 642   | 609               | 587  | 568  | 528  | 473  | 396  | 302  | 188  |        |           |             |           | 2331 | 56   |    |
| 6SDX (L) 18/56 | (37)           | (50)      | 653   | 620               | 597  | 579  | 538  | 482  | 403  | 307  | 192  |        |           |             |           | 2368 | 57   |    |
| 6SDX (L) 18/57 | (37)           | (50)      | 665   | 631               | 608  | 589  | 547  | 490  | 410  | 313  | 195  |        |           |             |           | 2406 | 58   |    |
| 6SDX (L) 18/58 | (37)           | (50)      | 677   | 642               | 619  | 599  | 557  | 499  | 418  | 318  | 198  |        |           |             |           | 2443 | 59   |    |
| 6SDX (L) 18/59 | (37)           | (50)      | 688   | 653               | 629  | 610  | 566  | 507  | 425  | 324  | 202  |        |           |             |           | 2481 | 60   |    |
| 6SDX (L) 18/60 | (37)           | (50)      | 700   | 664               | 640  | 620  | 576  | 516  | 432  | 329  | 205  |        |           |             |           | 2518 | 61   |    |

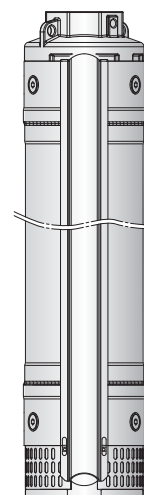
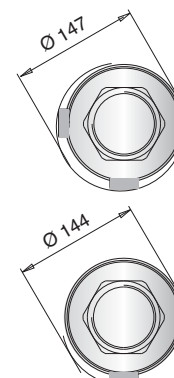
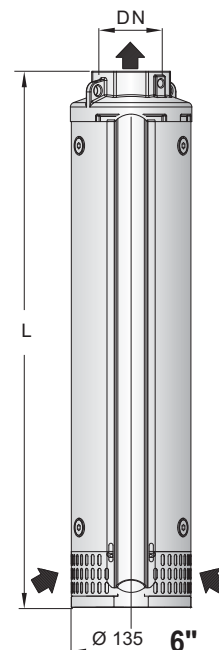

Collier spécial de renforcement à partir 6SDX(L) 13/50

# 6SDX 27

Pompes immergées pour puits de 6"



## Courbes caractéristiques

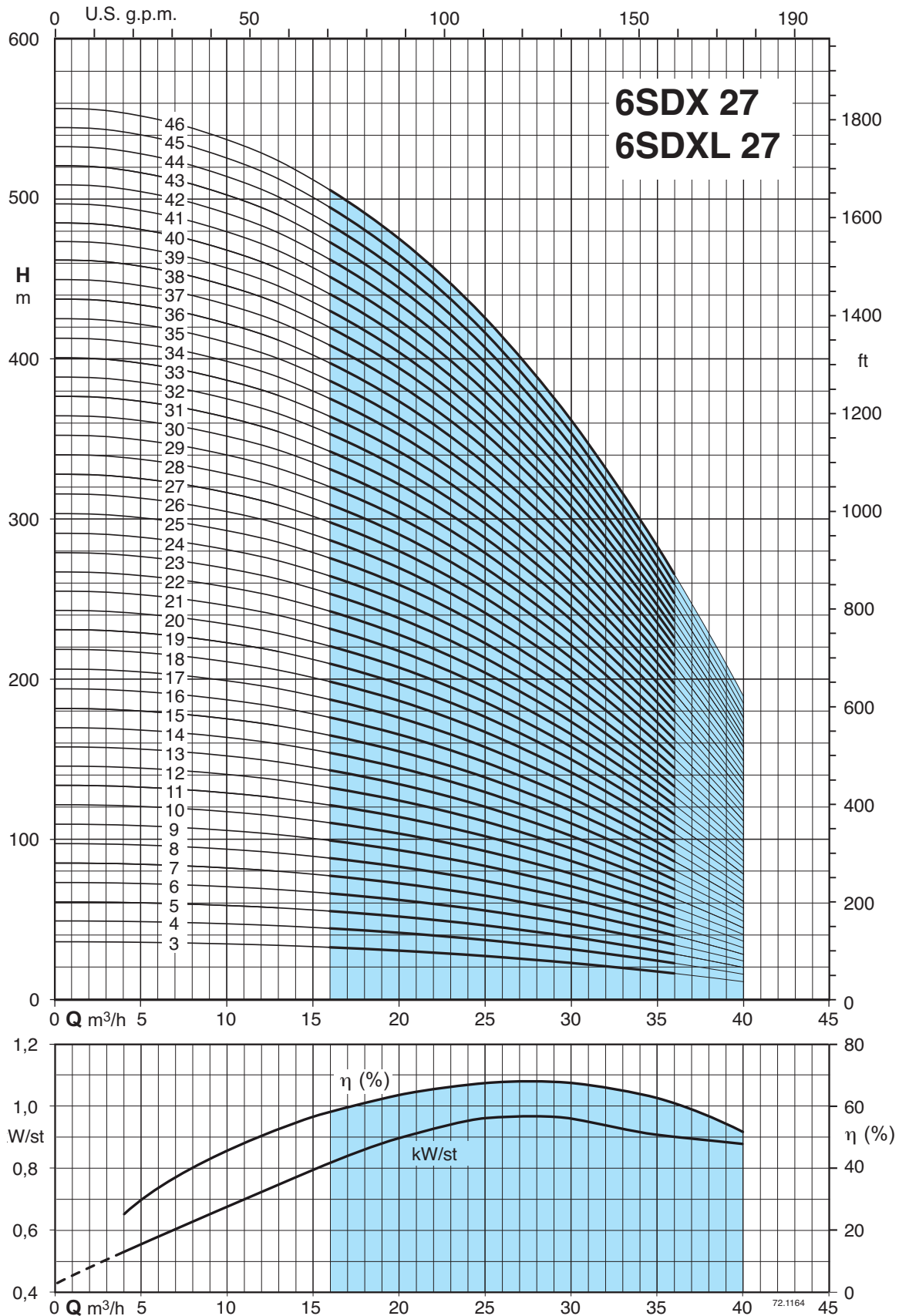

# 6SDX 27

Pompes immergées pour puits de 6"



## Performances n ≈ 2900 1/min, dimensions et poids

| 3 ~            | P <sub>2</sub> |           | Q      | n ≈ 2900 rpm      |      |      |      |      |     |      |     |     |           | DN      | Motore |      | L        | kg        |     |      |      |    |      |    |      |    |      |    |      |    |      |    |      |    |      |    |      |    |      |      |      |      |      |      |      |    |      |    |      |    |      |    |      |    |      |    |      |    |  |  |
|----------------|----------------|-----------|--------|-------------------|------|------|------|------|-----|------|-----|-----|-----------|---------|--------|------|----------|-----------|-----|------|------|----|------|----|------|----|------|----|------|----|------|----|------|----|------|----|------|----|------|------|------|------|------|------|------|----|------|----|------|----|------|----|------|----|------|----|------|----|--|--|
|                | kW             | HP        |        | m <sup>3</sup> /h | 0    | 16   | 20   | 24   | 28  | 32   | 36  | 40  | -         |         | CS     | FK   |          |           |     |      |      |    |      |    |      |    |      |    |      |    |      |    |      |    |      |    |      |    |      |      |      |      |      |      |      |    |      |    |      |    |      |    |      |    |      |    |      |    |  |  |
|                |                |           |        | l/min             | 0    | 266  | 333  | 400  | 466 | 533  | 600 | 666 | -         |         | mm     | mm   |          |           |     |      |      |    |      |    |      |    |      |    |      |    |      |    |      |    |      |    |      |    |      |      |      |      |      |      |      |    |      |    |      |    |      |    |      |    |      |    |      |    |  |  |
| 6SDX (L) 27/3  | 3              | 4         | H<br>m | 36,3              | 32,8 | 30,7 | 28,5 | 25,1 | 21  | 17,1 | 12  | -   | 145<br>6" | 96 - 4" | 481    | 11,5 |          |           |     |      |      |    |      |    |      |    |      |    |      |    |      |    |      |    |      |    |      |    |      |      |      |      |      |      |      |    |      |    |      |    |      |    |      |    |      |    |      |    |  |  |
| 6SDX (L) 27/4  | 4              | 5,5       |        | 48,4              | 43,8 | 41   | 38,1 | 33,4 | 28  | 22,8 | 16  |     |           |         |        |      | Rp<br>3" | 137<br>6" | 524 | 12,5 |      |    |      |    |      |    |      |    |      |    |      |    |      |    |      |    |      |    |      |      |      |      |      |      |      |    |      |    |      |    |      |    |      |    |      |    |      |    |  |  |
| 6SDX (L) 27/5  | 5,5            | 7,5       |        | 60,5              | 54,7 | 51,2 | 47,6 | 41,8 | 35  | 28,5 | 20  |     |           |         |        |      |          |           |     |      | 1361 | 30 |      |    |      |    |      |    |      |    |      |    |      |    |      |    |      |    |      |      |      |      |      |      |      |    |      |    |      |    |      |    |      |    |      |    |      |    |  |  |
| 6SDX (L) 27/6  | 7,5            | 10        |        | 72,6              | 65,7 | 61,5 | 57,1 | 50,1 | 42  | 34,2 | 24  |     |           |         |        |      |          |           |     |      |      |    | 1500 | 33 |      |    |      |    |      |    |      |    |      |    |      |    |      |    |      |      |      |      |      |      |      |    |      |    |      |    |      |    |      |    |      |    |      |    |  |  |
| 6SDX (L) 27/7  | 7,5            | 10        |        | 84,7              | 76,6 | 71,7 | 66,6 | 58,5 | 49  | 39,9 | 28  |     |           |         |        |      |          |           |     |      |      |    |      |    | 1640 | 36 |      |    |      |    |      |    |      |    |      |    |      |    |      |      |      |      |      |      |      |    |      |    |      |    |      |    |      |    |      |    |      |    |  |  |
| 6SDX (L) 27/8  | 11             | 15        |        | 96,8              | 87,5 | 81,9 | 76,1 | 66,9 | 56  | 45,6 | 32  |     |           |         |        |      |          |           |     |      |      |    |      |    |      |    | 1779 | 39 |      |    |      |    |      |    |      |    |      |    |      |      |      |      |      |      |      |    |      |    |      |    |      |    |      |    |      |    |      |    |  |  |
| 6SDX (L) 27/9  | 11             | 15        |        | 109               | 98,5 | 92,2 | 85,6 | 75,2 | 63  | 51,3 | 36  |     |           |         |        |      |          |           |     |      |      |    |      |    |      |    |      |    | 1826 | 40 |      |    |      |    |      |    |      |    |      |      |      |      |      |      |      |    |      |    |      |    |      |    |      |    |      |    |      |    |  |  |
| 6SDX (L) 27/10 | 11             | 15        |        | 121               | 109  | 102  | 95,1 | 83,6 | 70  | 57   | 40  |     |           |         |        |      |          |           |     |      |      |    |      |    |      |    |      |    |      |    | 1872 | 41 |      |    |      |    |      |    |      |      |      |      |      |      |      |    |      |    |      |    |      |    |      |    |      |    |      |    |  |  |
| 6SDX (L) 27/11 | 11             | 15        |        | 133               | 120  | 113  | 105  | 91,9 | 77  | 62,7 | 44  |     |           |         |        |      |          |           |     |      |      |    |      |    |      |    |      |    |      |    |      |    | 1919 | 42 |      |    |      |    |      |      |      |      |      |      |      |    |      |    |      |    |      |    |      |    |      |    |      |    |  |  |
| 6SDX (L) 27/12 | 13 (15)        | 17,5 (20) |        | 145               | 131  | 123  | 114  | 100  | 84  | 68,4 | 48  |     |           |         |        |      |          |           |     |      |      |    |      |    |      |    |      |    |      |    |      |    |      |    | 1965 | 43 |      |    |      |      |      |      |      |      |      |    |      |    |      |    |      |    |      |    |      |    |      |    |  |  |
| 6SDX (L) 27/13 | 13 (15)        | 17,5 (20) |        | 157               | 142  | 133  | 124  | 109  | 91  | 74,1 | 52  |     |           |         |        |      |          |           |     |      |      |    |      |    |      |    |      |    |      |    |      |    |      |    |      |    | 2012 | 44 |      |      |      |      |      |      |      |    |      |    |      |    |      |    |      |    |      |    |      |    |  |  |
| 6SDX (L) 27/14 | 15             | 20        |        | 169               | 153  | 143  | 133  | 117  | 98  | 79,8 | 56  |     |           |         |        |      |          |           |     |      |      |    |      |    |      |    |      |    |      |    |      |    |      |    |      |    |      |    | 2058 | 44,8 |      |      |      |      |      |    |      |    |      |    |      |    |      |    |      |    |      |    |  |  |
| 6SDX (L) 27/15 | 15             | 20        |        | 182               | 164  | 154  | 143  | 125  | 105 | 85,5 | 60  |     |           |         |        |      |          |           |     |      |      |    |      |    |      |    |      |    |      |    |      |    |      |    |      |    |      |    |      |      | 2105 | 45,5 |      |      |      |    |      |    |      |    |      |    |      |    |      |    |      |    |  |  |
| 6SDX (L) 27/16 | 18,5           | 25        |        | 194               | 175  | 164  | 152  | 134  | 112 | 91,2 | 64  |     |           |         |        |      |          |           |     |      |      |    |      |    |      |    |      |    |      |    |      |    |      |    |      |    |      |    |      |      |      |      | 2151 | 46,8 |      |    |      |    |      |    |      |    |      |    |      |    |      |    |  |  |
| 6SDX (L) 27/17 | 18,5           | 25        |        | 206               | 186  | 174  | 162  | 142  | 119 | 96,9 | 68  |     |           |         |        |      |          |           |     |      |      |    |      |    |      |    |      |    |      |    |      |    |      |    |      |    |      |    |      |      |      |      |      |      | 2197 | 48 |      |    |      |    |      |    |      |    |      |    |      |    |  |  |
| 6SDX (L) 27/18 | 18,5           | 25        |        | 218               | 197  | 184  | 171  | 150  | 126 | 103  | 72  |     |           |         |        |      |          |           |     |      |      |    |      |    |      |    |      |    |      |    |      |    |      |    |      |    |      |    |      |      |      |      |      |      |      |    | 2244 | 49 |      |    |      |    |      |    |      |    |      |    |  |  |
| 6SDX (L) 27/19 | 18,5           | 25        |        | 230               | 208  | 195  | 181  | 159  | 133 | 108  | 76  |     |           |         |        |      |          |           |     |      |      |    |      |    |      |    |      |    |      |    |      |    |      |    |      |    |      |    |      |      |      |      |      |      |      |    |      |    | 2290 | 50 |      |    |      |    |      |    |      |    |  |  |
| 6SDX (L) 27/20 | 22             | 30        |        | 242               | 219  | 205  | 190  | 167  | 140 | 114  | 80  |     |           |         |        |      |          |           |     |      |      |    |      |    |      |    |      |    |      |    |      |    |      |    |      |    |      |    |      |      |      |      |      |      |      |    |      |    |      |    | 2337 | 51 |      |    |      |    |      |    |  |  |
| 6SDX (L) 27/21 | 22             | 30        |        | 254               | 230  | 215  | 200  | 176  | 147 | 120  | 84  |     |           |         |        |      |          |           |     |      |      |    |      |    |      |    |      |    |      |    |      |    |      |    |      |    |      |    |      |      |      |      |      |      |      |    |      |    |      |    |      |    | 2383 | 52 |      |    |      |    |  |  |
| 6SDX (L) 27/22 | 22             | 30        |        | 266               | 241  | 225  | 209  | 184  | 154 | 125  | 88  |     |           |         |        |      |          |           |     |      |      |    |      |    |      |    |      |    |      |    |      |    |      |    |      |    |      |    |      |      |      |      |      |      |      |    |      |    |      |    |      |    |      |    | 2430 | 53 |      |    |  |  |
| 6SDX (L) 27/23 | 22             | 30        |        | 278               | 252  | 236  | 219  | 192  | 161 | 131  | 92  |     |           |         |        |      |          |           |     |      |      |    |      |    |      |    |      |    |      |    |      |    |      |    |      |    |      |    |      |      |      |      |      |      |      |    |      |    |      |    |      |    |      |    |      |    | 2476 | 54 |  |  |
| 6SDX (L) 27/24 | 26 (30)        | 35 (40)   |        | 290               | 263  | 246  | 228  | 201  | 168 | 137  | 96  |     |           |         |        |      |          |           |     |      |      |    |      |    |      |    |      |    |      |    |      |    |      |    |      |    |      |    |      |      |      |      |      |      |      |    |      |    |      |    |      |    |      |    |      |    |      |    |  |  |
| 6SDX (L) 27/25 | 26 (30)        | 35 (40)   |        | 303               | 274  | 256  | 238  | 209  | 175 | 143  | 100 |     |           |         |        |      |          |           |     |      |      |    |      |    |      |    |      |    |      |    |      |    |      |    |      |    |      |    |      |      |      |      |      |      |      |    |      |    |      |    |      |    |      |    |      |    |      |    |  |  |
| 6SDX (L) 27/26 | 26 (30)        | 35 (40)   |        | 315               | 285  | 266  | 247  | 217  | 182 | 148  | 104 |     |           |         |        |      |          |           |     |      |      |    |      |    |      |    |      |    |      |    |      |    |      |    |      |    |      |    |      |      |      |      |      |      |      |    |      |    |      |    |      |    |      |    |      |    |      |    |  |  |
| 6SDX (L) 27/27 | 26 (30)        | 35 (40)   |        | 327               | 296  | 277  | 257  | 226  | 189 | 154  | 108 |     |           |         |        |      |          |           |     |      |      |    |      |    |      |    |      |    |      |    |      |    |      |    |      |    |      |    |      |      |      |      |      |      |      |    |      |    |      |    |      |    |      |    |      |    |      |    |  |  |
| 6SDX (L) 27/28 | 30             | 40        |        | 339               | 306  | 287  | 266  | 234  | 196 | 160  | 112 |     |           |         |        |      |          |           |     |      |      |    |      |    |      |    |      |    |      |    |      |    |      |    |      |    |      |    |      |      |      |      |      |      |      |    |      |    |      |    |      |    |      |    |      |    |      |    |  |  |
| 6SDX (L) 27/29 | 30             | 40        |        | 351               | 317  | 297  | 276  | 242  | 203 | 165  | 116 |     |           |         |        |      |          |           |     |      |      |    |      |    |      |    |      |    |      |    |      |    |      |    |      |    |      |    |      |      |      |      |      |      |      |    |      |    |      |    |      |    |      |    |      |    |      |    |  |  |
| 6SDX (L) 27/30 | 30             | 40        |        | 363               | 328  | 307  | 285  | 251  | 210 | 171  | 120 |     |           |         |        |      |          |           |     |      |      |    |      |    |      |    |      |    |      |    |      |    |      |    |      |    |      |    |      |      |      |      |      |      |      |    |      |    |      |    |      |    |      |    |      |    |      |    |  |  |
| 6SDX (L) 27/31 | 30             | 40        |        | 375               | 339  | 318  | 295  | 259  | 217 | 177  | 124 |     |           |         |        |      |          |           |     |      |      |    |      |    |      |    |      |    |      |    |      |    |      |    |      |    |      |    |      |      |      |      |      |      |      |    |      |    |      |    |      |    |      |    |      |    |      |    |  |  |
| 6SDX (L) 27/32 | (37)           | (50)      |        | 387               | 350  | 328  | 305  | 267  | 224 | 182  | 128 |     |           |         |        |      |          |           |     |      |      |    |      |    |      |    |      |    |      |    |      |    |      |    |      |    |      |    |      |      |      |      |      |      |      |    |      |    |      |    |      |    |      |    |      |    |      |    |  |  |
| 6SDX (L) 27/33 | (37)           | (50)      |        | 399               | 361  | 338  | 314  | 276  | 231 | 188  | 132 |     |           |         |        |      |          |           |     |      |      |    |      |    |      |    |      |    |      |    |      |    |      |    |      |    |      |    |      |      |      |      |      |      |      |    |      |    |      |    |      |    |      |    |      |    |      |    |  |  |
| 6SDX (L) 27/34 | (37)           | (50)      |        | 411               | 372  | 348  | 324  | 284  | 238 | 194  | 136 |     |           |         |        |      |          |           |     |      |      |    |      |    |      |    |      |    |      |    |      |    |      |    |      |    |      |    |      |      |      |      |      |      |      |    |      |    |      |    |      |    |      |    |      |    |      |    |  |  |
| 6SDX (L) 27/35 | (37)           | (50)      |        | 424               | 383  | 359  | 333  | 293  | 245 | 200  | 140 |     |           |         |        |      |          |           |     |      |      |    |      |    |      |    |      |    |      |    |      |    |      |    |      |    |      |    |      |      |      |      |      |      |      |    |      |    |      |    |      |    |      |    |      |    |      |    |  |  |
| 6SDX (L) 27/36 | (37)           | (50)      |        | 436               | 394  | 369  | 343  | 301  | 252 | 205  | 144 |     |           |         |        |      |          |           |     |      |      |    |      |    |      |    |      |    |      |    |      |    |      |    |      |    |      |    |      |      |      |      |      |      |      |    |      |    |      |    |      |    |      |    |      |    |      |    |  |  |
| 6SDX (L) 27/37 | (37)           | (50)      |        | 448               | 405  | 379  | 352  | 309  | 259 | 211  | 148 |     |           |         |        |      |          |           |     |      |      |    |      |    |      |    |      |    |      |    |      |    |      |    |      |    |      |    |      |      |      |      |      |      |      |    |      |    |      |    |      |    |      |    |      |    |      |    |  |  |
| 6SDX (L) 27/38 | (37)           | (50)      |        | 460               | 416  | 389  | 362  | 318  | 266 | 217  | 152 |     |           |         |        |      |          |           |     |      |      |    |      |    |      |    |      |    |      |    |      |    |      |    |      |    |      |    |      |      |      |      |      |      |      |    |      |    |      |    |      |    |      |    |      |    |      |    |  |  |
| 6SDX (L) 27/39 | (45)           | (60)      |        | 472               | 427  | 400  | 371  | 326  | 273 | 222  | 156 |     |           |         |        |      |          |           |     |      |      |    |      |    |      |    |      |    |      |    |      |    |      |    |      |    |      |    |      |      |      |      |      |      |      |    |      |    |      |    |      |    |      |    |      |    |      |    |  |  |
| 6SDX (L) 27/40 | (45)           | (60)      |        | 484               | 438  | 410  | 381  | 334  | 280 | 228  | 160 |     |           |         |        |      |          |           |     |      |      |    |      |    |      |    |      |    |      |    |      |    |      |    |      |    |      |    |      |      |      |      |      |      |      |    |      |    |      |    |      |    |      |    |      |    |      |    |  |  |
| 6SDX (L) 27/41 | (45)           | (60)      |        | 496               | 449  | 420  | 390  | 343  | 287 | 234  | 164 |     |           |         |        |      |          |           |     |      |      |    |      |    |      |    |      |    |      |    |      |    |      |    |      |    |      |    |      |      |      |      |      |      |      |    |      |    |      |    |      |    |      |    |      |    |      |    |  |  |
| 6SDX (L) 27/42 | (45)           | (60)      |        | 508               | 460  | 430  | 400  | 351  | 294 | 239  | 168 |     |           |         |        |      |          |           |     |      |      |    |      |    |      |    |      |    |      |    |      |    |      |    |      |    |      |    |      |      |      |      |      |      |      |    |      |    |      |    |      |    |      |    |      |    |      |    |  |  |
| 6SDX (L) 27/43 | (45)           | (60)      |        | 520               | 471  | 440  | 409  | 359  | 301 | 245  | 172 |     |           |         |        |      |          |           |     |      |      |    |      |    |      |    |      |    |      |    |      |    |      |    |      |    |      |    |      |      |      |      |      |      |      |    |      |    |      |    |      |    |      |    |      |    |      |    |  |  |
| 6SDX (L) 27/44 | (45)           | (60)      |        | 532               | 482  | 451  | 419  | 368  | 308 | 251  | 176 |     |           |         |        |      |          |           |     |      |      |    |      |    |      |    |      |    |      |    |      |    |      |    |      |    |      |    |      |      |      |      |      |      |      |    |      |    |      |    |      |    |      |    |      |    |      |    |  |  |
| 6SDX (L) 27/45 | (45)           | (60)      |        | 545               | 492  | 461  | 428  | 376  | 315 | 257  | 180 |     |           |         |        |      |          |           |     |      |      |    |      |    |      |    |      |    |      |    |      |    |      |    |      |    |      |    |      |      |      |      |      |      |      |    |      |    |      |    |      |    |      |    |      |    |      |    |  |  |
| 6SDX (L) 27/46 | (45)           | (60)      |        | 557               | 503  | 471  | 438  | 384  | 322 | 262  | 184 |     |           |         |        |      |          |           |     |      |      |    |      |    |      |    |      |    |      |    |      |    |      |    |      |    |      |    |      |      |      |      |      |      |      |    |      |    |      |    |      |    |      |    |      |    |      |    |  |  |

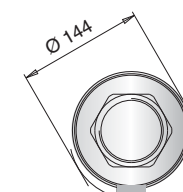
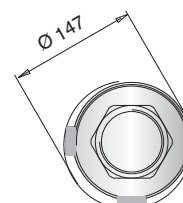
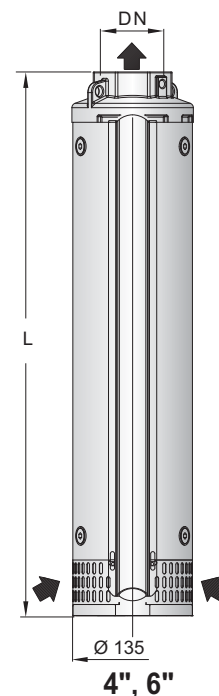



# 6SDX 30

Pompes immergées pour puits de 6"



## Courbes caractéristiques

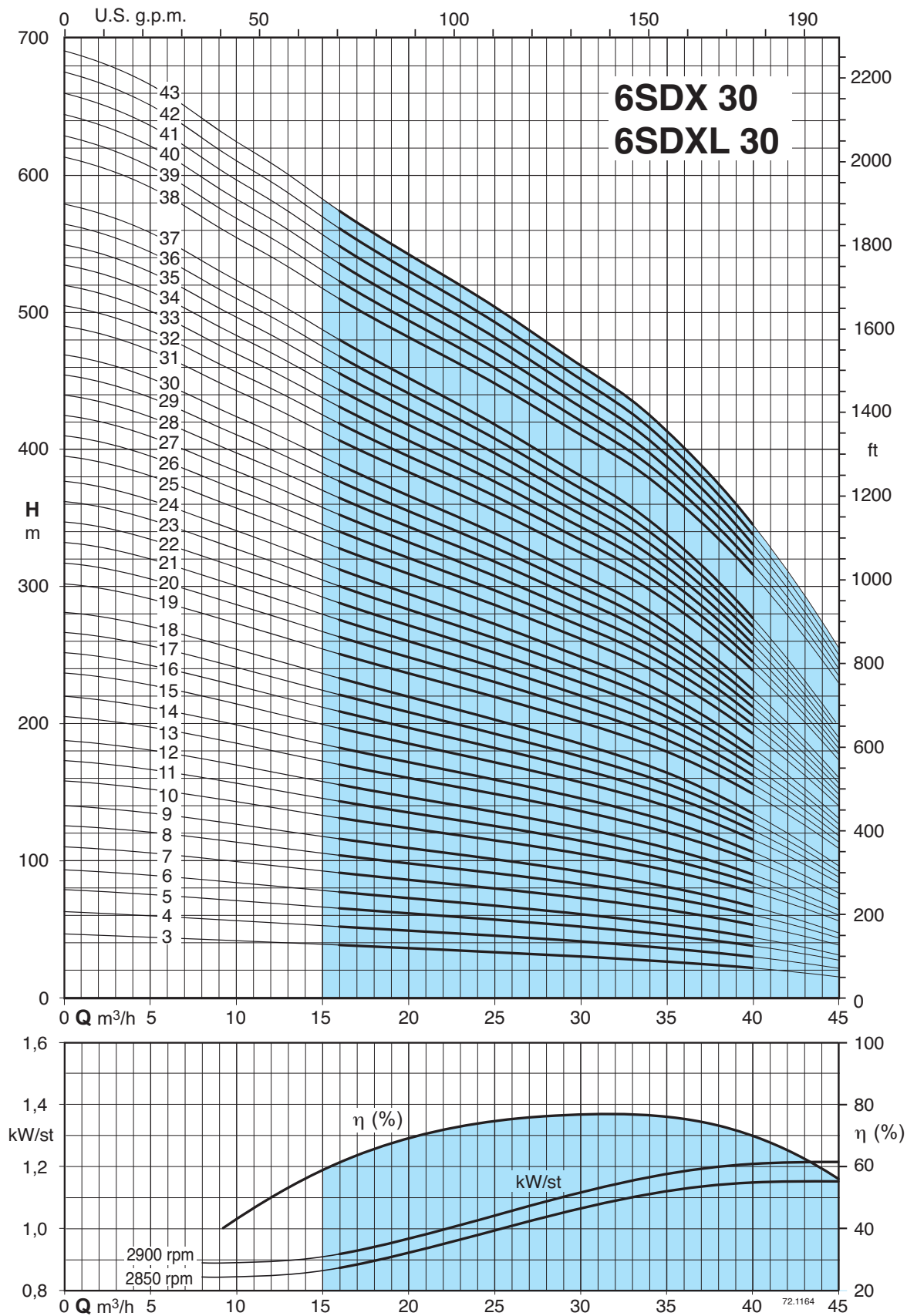

# 6SDX 30

Pompes immergées pour puits de 6"



## Performances n ≈ 2900 1/min, dimensions et poids

| 3 ~            | P <sub>2</sub> |           | Q    | n ≈ 2900 1/min    |       |      |      |      |      |      |       |        |          | DN        | Motore    |          | L    | kg |  |
|----------------|----------------|-----------|------|-------------------|-------|------|------|------|------|------|-------|--------|----------|-----------|-----------|----------|------|----|--|
|                | kW             | HP        |      | m <sup>3</sup> /h | l/min |      |      |      |      |      |       |        |          |           | CS<br>mm  | FK<br>mm |      |    |  |
|                |                |           |      | 0                 | 15    | 20   | 25   | 30   | 35   | 40   | 45    | -      |          |           |           |          |      |    |  |
| 6SDX (L) 30/3  | 4              | 5,5       | 46,3 | 38,9              | 36    | 33,3 | 30,2 | 26,7 | 21,7 | 15,3 | -     | H<br>m | Rp<br>3" | 145<br>6" | 137<br>6" | 620      | 14,7 |    |  |
| 6SDX (L) 30/4  | 5,5            | 7,5       | 62,5 | 52,6              | 48,8  | 45,2 | 41,1 | 36,5 | 30   | 21,4 | 705   |        |          |           |           | 16,8     |      |    |  |
| 6SDX (L) 30/5  | 7,5            | 10        | 78,6 | 66,2              | 61,5  | 56,9 | 51,8 | 46,1 | 38   | 27,4 | 790   |        |          |           |           | 18,9     |      |    |  |
| 6SDX (L) 30/6  | 7,5            | 10        | 93,1 | 78,4              | 72,6  | 67,1 | 61   | 54   | 44,1 | 31,2 | 876   |        |          |           |           | 21       |      |    |  |
| 6SDX (L) 30/7  | 9,2            | 12,5      | 110  | 92,6              | 86    | 79,7 | 72,6 | 64,6 | 53,3 | 38,4 | 961,5 |        |          |           |           | 23,1     |      |    |  |
| 6SDX (L) 30/8  | 11             | 15        | 125  | 106               | 98,1  | 90,9 | 82,7 | 73,6 | 60,5 | 43,5 | 1047  |        |          |           |           | 25,4     |      |    |  |
| 6SDX (L) 30/9  | 11             | 15        | 140  | 118               | 109   | 101  | 91,8 | 81,4 | 66,6 | 47,3 | 1132  |        |          |           |           | 27,3     |      |    |  |
| 6SDX (L) 30/10 | 13 (15)        | 17,5 (20) | 158  | 133               | 124   | 115  | 105  | 93,5 | 77,3 | 56,1 | 1218  |        |          |           |           | 29,4     |      |    |  |
| 6SDX (L) 30/11 | 15             | 20        | 173  | 146               | 135   | 125  | 114  | 102  | 83,8 | 60,4 | 1303  |        |          |           |           | 31,5     |      |    |  |
| 6SDX (L) 30/12 | 15             | 20        | 188  | 158               | 147   | 136  | 123  | 110  | 90   | 64,4 | 1389  |        |          |           |           | 33,6     |      |    |  |
| 6SDX (L) 30/13 | 18,5           | 25        | 205  | 173               | 161   | 149  | 136  | 121  | 100  | 72,4 | 1474  |        |          |           |           | 35,7     |      |    |  |
| 6SDX (L) 30/14 | 18,5           | 25        | 220  | 185               | 172   | 159  | 145  | 129  | 106  | 76,7 | 1560  |        |          |           |           | 37,8     |      |    |  |
| 6SDX (L) 30/15 | 22             | 30        | 237  | 200               | 185   | 172  | 157  | 140  | 116  | 84   | 1645  |        |          |           |           | 39,9     |      |    |  |
| 6SDX (L) 30/16 | 22             | 30        | 252  | 212               | 197   | 183  | 166  | 148  | 122  | 88,3 | 1730  |        |          |           |           | 42       |      |    |  |
| 6SDX (L) 30/17 | 22             | 30        | 267  | 224               | 208   | 193  | 176  | 156  | 129  | 92,5 | 1816  |        |          |           |           | 44,1     |      |    |  |
| 6SDX (L) 30/18 | 22             | 30        | 281  | 237               | 220   | 203  | 185  | 164  | 135  | 96,5 | 1901  |        |          |           |           | 46,1     |      |    |  |
| 6SDX (L) 30/19 | 26 (30)        | 35 (40)   | 302  | 255               | 237   | 220  | 201  | 180  | 149  | 109  | 1987  |        |          |           |           | 48,2     |      |    |  |
| 6SDX (L) 30/20 | 26 (30)        | 35 (40)   | 317  | 267               | 249   | 231  | 210  | 188  | 156  | 114  | 2072  |        |          |           |           | 50,3     |      |    |  |
| 6SDX (L) 30/21 | 26 (30)        | 35 (40)   | 332  | 280               | 260   | 241  | 220  | 197  | 163  | 118  | 2157  |        |          |           |           | 52,4     |      |    |  |
| 6SDX (L) 30/22 | 30             | 40        | 347  | 293               | 272   | 252  | 230  | 205  | 169  | 123  | 2243  |        |          |           |           | 54,5     |      |    |  |
| 6SDX (L) 30/23 | 30             | 40        | 362  | 305               | 283   | 263  | 239  | 213  | 176  | 127  | 2328  |        |          |           |           | 56,6     |      |    |  |
| 6SDX (L) 30/24 | 30             | 40        | 377  | 317               | 295   | 273  | 249  | 221  | 182  | 131  | 2414  |        |          |           |           | 58,7     |      |    |  |
| 6SDX (L) 30/25 | 37             | 50        | 395  | 333               | 309   | 287  | 261  | 233  | 193  | 140  | 2499  |        |          |           |           | 60,8     |      |    |  |
| 6SDX (L) 30/26 | 37             | 50        | 410  | 345               | 321   | 297  | 271  | 242  | 200  | 144  | 2584  |        |          |           |           | 62,9     |      |    |  |
| 6SDX (L) 30/27 | 37             | 50        | 425  | 358               | 332   | 308  | 280  | 250  | 206  | 149  | 2670  |        |          |           |           | 65       |      |    |  |
| 6SDX (L) 30/28 | 37             | 50        | 440  | 370               | 344   | 318  | 290  | 258  | 212  | 153  | 2755  |        |          |           |           | 67,2     |      |    |  |
| 6SDX (L) 30/29 | 37             | 50        | 454  | 383               | 355   | 329  | 299  | 266  | 219  | 157  | 2840  |        |          |           |           | 69,2     |      |    |  |
| 6SDX (L) 30/30 | 37             | 50        | 469  | 395               | 366   | 339  | 308  | 274  | 225  | 161  | 2926  |        |          |           |           | 71,3     |      |    |  |
| 6SDX (L) 30/31 | 45             | 60        | 490  | 413               | 384   | 356  | 324  | 289  | 239  | 174  | 3011  |        |          |           |           | 75,2     |      |    |  |
| 6SDX (L) 30/32 | 45             | 60        | 505  | 425               | 395   | 366  | 334  | 298  | 246  | 178  | 3096  |        |          |           |           | 78,3     |      |    |  |
| 6SDX (L) 30/33 | 45             | 60        | 520  | 438               | 407   | 377  | 343  | 306  | 252  | 182  | 3182  |        |          |           |           | 80,4     |      |    |  |
| 6SDX (L) 30/34 | 45             | 60        | 535  | 450               | 418   | 387  | 353  | 314  | 259  | 186  | 3267  |        |          |           |           | 82,5     |      |    |  |
| 6SDX (L) 30/35 | 45             | 60        | 549  | 463               | 429   | 398  | 362  | 322  | 265  | 190  | 3352  |        |          |           |           | 84,6     |      |    |  |
| 6SDX (L) 30/36 | 45             | 60        | 564  | 475               | 441   | 408  | 371  | 330  | 271  | 194  | 3438  |        |          |           |           | 87,9     |      |    |  |
| 6SDX (L) 30/37 | 45             | 60        | 579  | 487               | 452   | 418  | 380  | 338  | 277  | 198  | 3523  |        |          |           |           | 90       |      |    |  |
| 6SDX (L) 30/38 | 51 (55)        | 70 (75)   | 613  | 517               | 482   | 448  | 410  | 369  | 309  | 229  | 3709  |        |          |           |           | 92,3     |      |    |  |
| 6SDX (L) 30/39 | 51 (55)        | 70 (75)   | 628  | 530               | 494   | 459  | 420  | 378  | 316  | 234  | 3794  |        |          |           |           | 94,5     |      |    |  |
| 6SDX (L) 30/40 | 51 (55)        | 70 (75)   | 644  | 543               | 506   | 471  | 430  | 387  | 323  | 240  | 3879  |        |          |           |           | 96,6     |      |    |  |
| 6SDX (L) 30/41 | 51 (55)        | 70 (75)   | 659  | 557               | 518   | 482  | 440  | 396  | 330  | 245  | 3965  |        |          |           |           | 97,6     |      |    |  |
| 6SDX (L) 30/42 | 55             | 75        | 675  | 569               | 530   | 493  | 450  | 404  | 338  | 250  | 4050  |        |          |           |           | 98,7     |      |    |  |
| 6SDX (L) 30/43 | 55             | 75        | 690  | 582               | 542   | 504  | 460  | 413  | 345  | 255  | 4135  |        |          |           |           | 99,8     |      |    |  |

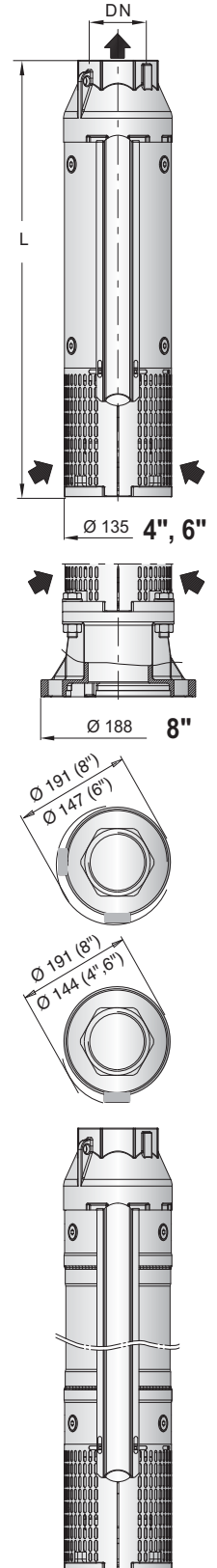

Collier spécial de renforcement à partir 6SDX(L) 13/50

# 6SDX 46

Pompes immergées pour puits de 6"



## Courbes caractéristiques

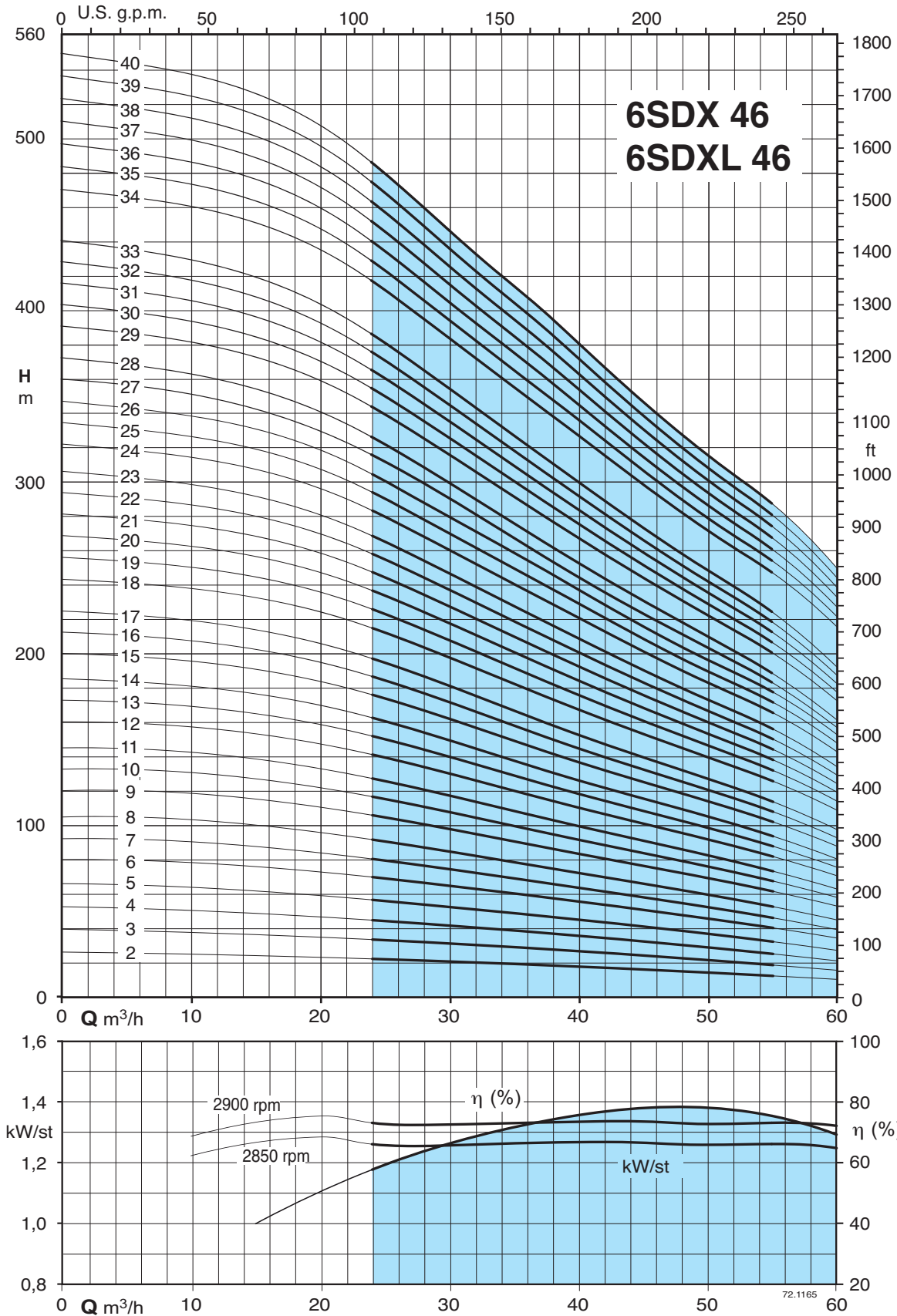

# 6SDX 46

Pompes immergées pour puits de 6"



## Performances n ≈ 2900 1/min, dimensions et poids

| 3 ~            | P <sub>2</sub> |           | Q | n ≈ 2900 1/min    |      |      |      |      |      |      |      |      |   |   |         | DN      | Motore |      | L | kg |
|----------------|----------------|-----------|---|-------------------|------|------|------|------|------|------|------|------|---|---|---------|---------|--------|------|---|----|
|                | kW             | HP        |   | m <sup>3</sup> /h | H m  |      |      |      |      |      |      |      |   |   |         |         | CS     | FK   |   |    |
|                |                |           | 0 |                   | 25   | 30   | 35   | 40   | 45   | 50   | 55   | 60   | - | - | -       |         |        |      |   |    |
| 6SDX (L) 46/2  | 3              | 4         |   | 26,4              | 22,6 | 20,9 | 19,3 | 17,8 | 16,6 | 15,1 | 13,4 | 11,3 | - | - | 96 - 4" | 96 - 4" | 594    | 13,5 |   |    |
| 6SDX (L) 46/3  | 4              | 5,5       |   | 39,4              | 33,8 | 31,2 | 28,8 | 26,6 | 24,7 | 22,5 | 19,9 | 16,8 |   |   |         |         | 705    | 16,2 |   |    |
| 6SDX (L) 46/4  | 5,5            | 7,5       |   | 52,5              | 45   | 41,5 | 38,3 | 35,5 | 32,9 | 29,9 | 26,5 | 22,3 |   |   |         |         | 819    | 18,8 |   |    |
| 6SDX (L) 46/5  | 7,5            | 10        |   | 66,1              | 56,8 | 52,3 | 48,3 | 44,7 | 41,5 | 37,8 | 33,6 | 28,4 |   |   |         |         | 933    | 21,4 |   |    |
| 6SDX (L) 46/6  | 9,2            | 12,5      |   | 80,7              | 70   | 65,2 | 60,4 | 55,5 | 50,3 | 46   | 41,6 | 35,7 |   |   |         |         | 1047   | 24,0 |   |    |
| 6SDX (L) 46/7  | 9,2            | 12,5      |   | 93,1              | 80,4 | 74,8 | 69,3 | 63,5 | 57,6 | 52,7 | 47,5 | 40,5 |   |   |         |         | 1161   | 26,6 |   |    |
| 6SDX (L) 46/8  | 11             | 15        |   | 106               | 91,6 | 85,1 | 78,9 | 72,2 | 65,5 | 59,9 | 54   | 46   |   |   |         |         | 1275   | 29,2 |   |    |
| 6SDX (L) 46/9  | 13 (15)        | 17,5 (20) |   | 121               | 105  | 98,2 | 91   | 83,7 | 75,9 | 69,5 | 62,9 | 54,1 |   |   |         |         | 1389   | 31,8 |   |    |
| 6SDX (L) 46/10 | 13 (15)        | 17,5 (20) |   | 134               | 116  | 108  | 100  | 91,9 | 83,3 | 76,2 | 68,9 | 59   |   |   |         |         | 1503   | 34,4 |   |    |
| 6SDX (L) 46/11 | 15             | 20        |   | 146               | 126  | 118  | 109  | 99,9 | 90,5 | 82,8 | 74,7 | 63,7 |   |   | 145 6"  |         | 1617   | 37,0 |   |    |
| 6SDX (L) 46/12 | 18,5           | 25        |   | 161               | 140  | 130  | 12   | 111  | 101  | 92   | 83,3 | 71,4 |   |   |         |         | 1730   | 39,6 |   |    |
| 6SDX (L) 46/13 | 18,5           | 25        |   | 174               | 150  | 140  | 130  | 119  | 108  | 98,7 | 89,2 | 76,3 |   |   |         |         | 1844   | 42,2 |   |    |
| 6SDX (L) 46/14 | 18,5           | 25        |   | 186               | 161  | 149  | 139  | 127  | 115  | 105  | 95   | 81   |   |   |         |         | 1958   | 44,8 |   |    |
| 6SDX (L) 46/15 | 22             | 30        |   | 201               | 174  | 162  | 150  | 138  | 125  | 114  | 103  | 88,4 |   |   | 137 6"  |         | 2072   | 47,4 |   |    |
| 6SDX (L) 46/16 | 22             | 30        |   | 213               | 184  | 171  | 159  | 146  | 132  | 121  | 109  | 93,2 |   |   |         |         | 2186   | 50,1 |   |    |
| 6SDX (L) 46/17 | 22             | 30        |   | 225               | 195  | 181  | 168  | 154  | 139  | 127  | 115  | 97,8 |   |   |         |         | 2300   | 52,7 |   |    |
| 6SDX (L) 46/18 | 26 (30)        | 35 (40)   |   | 244               | 212  | 198  | 183  | 169  | 153  | 140  | 127  | 109  |   |   |         |         | 2414   | 55,3 |   |    |
| 6SDX (L) 46/19 | 26 (30)        | 35 (40)   |   | 257               | 223  | 208  | 192  | 177  | 160  | 147  | 133  | 114  |   |   |         |         | 2527   | 57,9 |   |    |
| 6SDX (L) 46/20 | 30             | 40        |   | 269               | 234  | 218  | 208  | 185  | 168  | 154  | 139  | 119  |   |   |         |         | 2641   | 60,5 |   |    |
| 6SDX (L) 46/21 | 30             | 40        |   | 282               | 244  | 227  | 211  | 193  | 175  | 160  | 145  | 124  |   |   |         |         | 2755   | 63,1 |   |    |
| 6SDX (L) 46/22 | 30             | 40        |   | 294               | 255  | 237  | 220  | 202  | 183  | 167  | 151  | 129  |   |   |         |         | 2869   | 65,7 |   |    |
| 6SDX (L) 46/23 | 30             | 40        |   | 307               | 265  | 247  | 229  | 209  | 190  | 174  | 157  | 134  |   |   |         |         | 2983   | 68,3 |   |    |
| 6SDX (L) 46/24 | 37             | 50        |   | 322               | 280  | 260  | 241  | 222  | 201  | 184  | 166  | 143  |   |   |         |         | 3096   | 70,9 |   |    |
| 6SDX (L) 46/25 | 37             | 50        |   | 335               | 290  | 270  | 250  | 230  | 208  | 191  | 172  | 147  |   |   |         |         | 3210   | 73,5 |   |    |
| 6SDX (L) 46/26 | 37             | 50        |   | 347               | 301  | 280  | 259  | 238  | 216  | 197  | 178  | 152  |   |   |         |         | 3324   | 76,1 |   |    |
| 6SDX (L) 46/27 | 37             | 50        |   | 360               | 311  | 289  | 268  | 246  | 223  | 204  | 184  | 157  |   |   |         |         | 3438   | 79,3 |   |    |
| 6SDX (L) 46/28 | 37             | 50        |   | 372               | 321  | 299  | 277  | 254  | 230  | 210  | 190  | 162  |   |   |         |         | 3552   | 82,0 |   |    |
| 6SDX (L) 46/29 | 45             | 60        |   | 390               | 339  | 315  | 292  | 268  | 243  | 223  | 201  | 173  |   |   |         |         | 3665   | 87,4 |   |    |
| 6SDX (L) 46/30 | 45             | 60        |   | 403               | 349  | 325  | 301  | 276  | 251  | 229  | 207  | 178  |   |   |         |         | 3779   | 90,0 |   |    |
| 6SDX (L) 46/31 | 45             | 60        |   | 415               | 360  | 334  | 310  | 284  | 258  | 236  | 213  | 183  |   |   | 191 8"  |         | 3893   | 92,6 |   |    |
| 6SDX (L) 46/32 | 45             | 60        |   | 427               | 370  | 344  | 319  | 292  | 265  | 243  | 219  | 187  |   |   |         |         | 4007   | 95,2 |   |    |
| 6SDX (L) 46/33 | 45             | 60        |   | 440               | 380  | 353  | 328  | 300  | 272  | 249  | 225  | 192  |   |   |         |         | 4121   | 97,8 |   |    |
| 6SDX (L) 46/34 | 51 (55)        | 70 (75)   |   | 469               | 411  | 383  | 355  | 328  | 298  | 272  | 248  | 216  |   |   |         |         | 4335   | 101  |   |    |
| 6SDX (L) 46/35 | 51 (55)        | 70 (75)   |   | 482               | 422  | 394  | 365  | 337  | 306  | 279  | 255  | 221  |   |   |         |         | 4449   | 103  |   |    |
| 6SDX (L) 46/36 | 51 (55)        | 70 (75)   |   | 496               | 434  | 404  | 374  | 346  | 314  | 287  | 261  | 227  |   |   |         |         | 4562   | 106  |   |    |
| 6SDX (L) 46/37 | 51 (55)        | 70 (75)   |   | 509               | 445  | 415  | 384  | 355  | 322  | 294  | 268  | 233  |   |   |         |         | 4676   | 109  |   |    |
| 6SDX (L) 46/38 | 55             | 75        |   | 522               | 456  | 425  | 394  | 364  | 330  | 302  | 275  | 238  |   |   |         |         | 4790   | 111  |   |    |
| 6SDX (L) 46/39 | 55             | 75        |   | 535               | 467  | 436  | 403  | 372  | 338  | 309  | 281  | 244  |   |   |         |         | 4904   | 114  |   |    |
| 6SDX (L) 46/40 | 55             | 75        |   | 548               | 479  | 446  | 413  | 381  | 346  | 316  | 288  | 249  |   |   |         |         | 5018   | 117  |   |    |

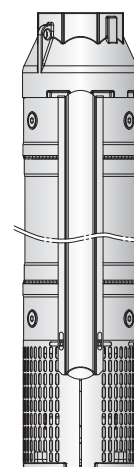
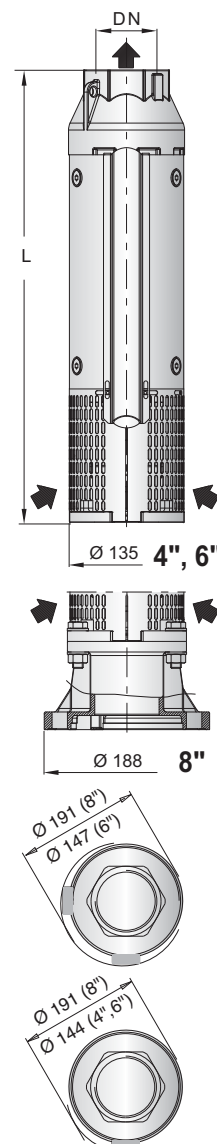

Collier spécial de renforcement à partir 6SDX(L) 13/50

# 6SDX 65

Pompes immergées pour puits de 6"



## Courbes caractéristiques

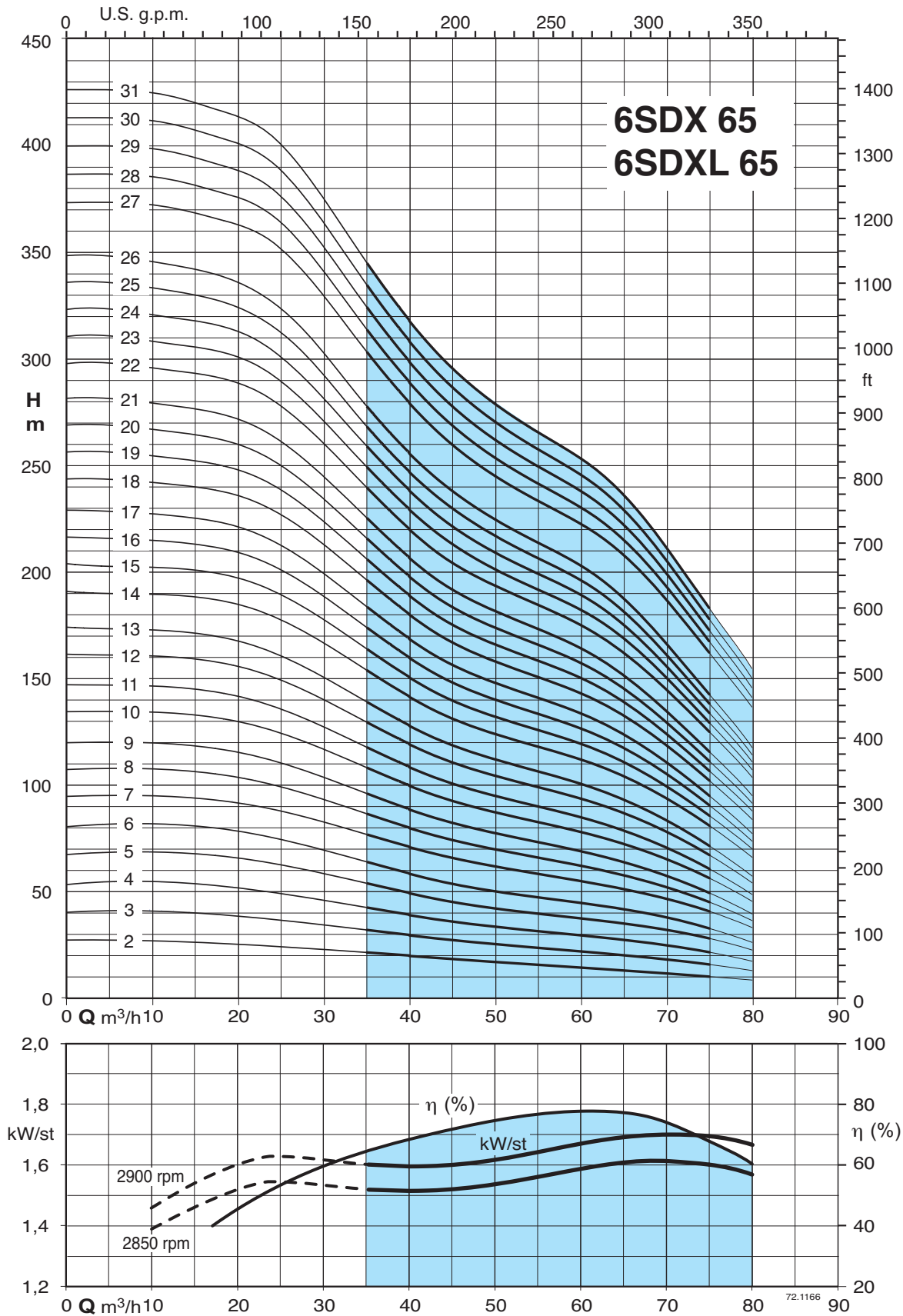



# 6SDX 65

Pompes immergées pour puits de 6"



## Performances n ≈ 2900 1/min, dimensions et poids

| 3 ~            | P <sub>2</sub> |           | Q    | n ≈ 2900 1/min    |      |      |      |      |      |      |      |      |      |      |      | DN       | Motore    |           |      | L    | kg |
|----------------|----------------|-----------|------|-------------------|------|------|------|------|------|------|------|------|------|------|------|----------|-----------|-----------|------|------|----|
|                |                |           |      | m <sup>3</sup> /h |      |      |      |      |      |      |      |      |      |      |      |          | CS        | FK        | mm   |      |    |
|                | kW             | HP        |      | l/min             | 0    | 35   | 40   | 45   | 50   | 55   | 60   | 65   | 70   | 75   | 80   |          |           |           |      |      |    |
| 6SDX (L) 65/2  | 4              | 5,5       | 26,8 | 21,1              | 19   | 17,3 | 16,5 | 15,7 | 14,9 | 13,9 | 12,4 | 10,5 | 8,2  | 592  | 13,6 | Rp<br>3" | 145<br>6" | 137<br>6" | 705  | 16,2 |    |
| 6SDX (L) 65/3  | 5,5            | 7,5       | 40,4 | 31,8              | 28,8 | 26,2 | 24,9 | 23,7 | 22,5 | 21   | 18,9 | 16   | 12,6 | 819  | 18,8 |          |           |           | 1503 | 34,5 |    |
| 6SDX (L) 65/4  | 7,5            | 10        | 54   | 42,5              | 38,4 | 35   | 33,2 | 31,6 | 30,1 | 28   | 25,2 | 21,4 | 16,9 | 933  | 21,4 |          |           |           | 1617 | 37,1 |    |
| 6SDX (L) 65/5  | 9,2            | 12,5      | 68   | 53,8              | 48,7 | 44,3 | 41,9 | 40,1 | 38,2 | 35,6 | 32,2 | 27,5 | 22   | 1047 | 24,0 |          |           |           | 1730 | 39,7 |    |
| 6SDX (L) 65/6  | 11             | 15        | 81,2 | 64                | 57,9 | 52,7 | 50   | 47,7 | 45,3 | 42,3 | 38,1 | 32,3 | 25,7 | 1161 | 26,7 |          |           |           | 1844 | 42,4 |    |
| 6SDX (L) 65/7  | 13 (15)        | 17,5 (20) | 94,9 | 76,2              | 70,1 | 65,2 | 61,7 | 58,6 | 55,7 | 52,1 | 46,1 | 39,7 | 33,4 | 1275 | 29,3 |          |           |           | 1958 | 44,9 |    |
| 6SDX (L) 65/8  | 15             | 20        | 108  | 86                | 79,1 | 73,5 | 69,7 | 66,1 | 62,8 | 58,5 | 51,6 | 44,3 | 37   | 1389 | 31,9 |          |           |           | 2072 | 47,5 |    |
| 6SDX (L) 65/9  | 15             | 20        | 120  | 95,5              | 87,8 | 81,5 | 77,4 | 73,4 | 69,6 | 64,6 | 56,8 | 48,6 | 40,2 | 1503 | 34,5 |          |           |           | 2186 | 50,2 |    |
| 6SDX (L) 65/10 | 18,5           | 25        | 134  | 108               | 99   | 91,9 | 87,2 | 82,7 | 78,5 | 73,2 | 64,6 | 55,5 | 46,3 | 1617 | 37,1 |          |           |           | 2299 | 52,8 |    |
| 6SDX (L) 65/11 | 18,5           | 25        | 147  | 117               | 108  | 100  | 95   | 90   | 85,4 | 79,4 | 69,8 | 59,9 | 49,6 | 1730 | 39,7 |          |           |           | 2414 | 55,4 |    |
| 6SDX (L) 65/12 | 22             | 30        | 161  | 129               | 118  | 110  | 104  | 99,1 | 94,1 | 87,6 | 77,3 | 66,3 | 55,3 | 1844 | 42,4 |          |           |           | 2527 | 58,0 |    |
| 6SDX (L) 65/13 | 22             | 30        | 174  | 138               | 127  | 118  | 112  | 106  | 101  | 93,8 | 82,5 | 70,8 | 58,6 | 1958 | 44,9 |          |           |           | 2641 | 60,7 |    |
| 6SDX (L) 65/14 | 26 (30)        | 35 (40)   | 190  | 153               | 141  | 131  | 124  | 118  | 112  | 105  | 93   | 80,2 | 67,7 | 2072 | 47,5 |          |           |           | 2755 | 63,3 |    |
| 6SDX (L) 65/15 | 26 (30)        | 35 (40)   | 203  | 163               | 150  | 140  | 132  | 126  | 119  | 111  | 98,7 | 85   | 71,5 | 2186 | 50,2 |          |           |           | 2869 | 68,7 |    |
| 6SDX (L) 65/16 | 30             | 40        | 216  | 173               | 159  | 148  | 140  | 133  | 126  | 118  | 104  | 89,7 | 75,2 | 2300 | 52,8 |          |           |           | 2983 | 71,3 |    |
| 6SDX (L) 65/17 | 30             | 40        | 229  | 183               | 168  | 156  | 148  | 141  | 133  | 124  | 110  | 94,3 | 78,8 | 2414 | 55,4 |          | 3096      | 73,9      |      |      |    |
| 6SDX (L) 65/18 | 37             | 50        | 243  | 195               | 180  | 167  | 158  | 150  | 143  | 133  | 118  | 101  | 85,2 | 2527 | 58,0 |          | 3210      | 76,5      |      |      |    |
| 6SDX (L) 65/19 | 37             | 50        | 256  | 205               | 189  | 175  | 166  | 158  | 150  | 140  | 123  | 106  | 88,9 | 2641 | 60,7 |          | 3324      | 79,1      |      |      |    |
| 6SDX (L) 65/20 | 37             | 50        | 269  | 215               | 198  | 184  | 174  | 165  | 157  | 146  | 129  | 111  | 92,4 | 2755 | 63,3 |          | 3538      | 82,6      |      |      |    |
| 6SDX (L) 65/21 | 37             | 50        | 281  | 225               | 206  | 192  | 182  | 173  | 164  | 152  | 134  | 115  | 95,7 | 2869 | 68,7 |          | 3652      | 85,3      |      |      |    |
| 6SDX (L) 65/22 | 45             | 60        | 298  | 239               | 220  | 204  | 194  | 184  | 175  | 163  | 144  | 124  | 104  | 2983 | 71,3 |          | 3765      | 87,9      |      |      |    |
| 6SDX (L) 65/23 | 45             | 60        | 310  | 249               | 229  | 213  | 202  | 191  | 182  | 170  | 150  | 129  | 108  | 3096 | 73,9 |          | 3879      | 90,5      |      |      |    |
| 6SDX (L) 65/24 | 45             | 60        | 323  | 259               | 238  | 221  | 209  | 199  | 189  | 176  | 155  | 133  | 111  | 3210 | 76,5 |          | 3993      | 93,2      |      |      |    |
| 6SDX (L) 65/25 | 45             | 60        | 336  | 268               | 247  | 229  | 217  | 206  | 196  | 182  | 161  | 138  | 115  | 3324 | 79,1 |          |           |           |      |      |    |
| 6SDX (L) 65/26 | 45             | 60        | 348  | 278               | 255  | 237  | 225  | 213  | 202  | 188  | 166  | 142  | 118  | 3538 | 82,6 |          |           |           |      |      |    |
| 6SDX (L) 65/27 | 51 (55)        | 70 (75)   | 373  | 303               | 279  | 259  | 245  | 233  | 222  | 208  | 186  | 162  | 137  | 3652 | 85,3 |          |           |           |      |      |    |
| 6SDX (L) 65/28 | 51 (55)        | 70 (75)   | 386  | 313               | 288  | 268  | 253  | 241  | 229  | 216  | 193  | 167  | 142  | 3765 | 87,9 |          |           |           |      |      |    |
| 6SDX (L) 65/29 | 51 (55)        | 70 (75)   | 399  | 324               | 298  | 277  | 262  | 249  | 237  | 223  | 199  | 172  | 146  | 3879 | 90,5 |          |           |           |      |      |    |
| 6SDX (L) 65/30 | 55             | 75        | 413  | 334               | 308  | 286  | 270  | 258  | 245  | 230  | 205  | 177  | 151  | 3993 | 93,2 |          |           |           |      |      |    |
| 6SDX (L) 65/31 | 55             | 75        | 426  | 345               | 317  | 295  | 279  | 265  | 252  | 237  | 211  | 183  | 155  |      |      |          |           |           |      |      |    |

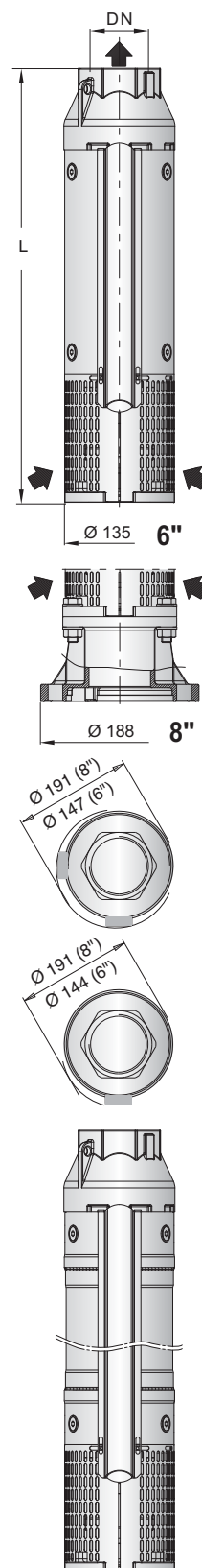

Collier spécial de renforcement à partir 6SDX(L) 13/50

# 8SDXL 78

Pompes immergées pour puits de 8"



## Courbes caractéristiques et performances n ≈ 2900 1/min, dimensions et poids

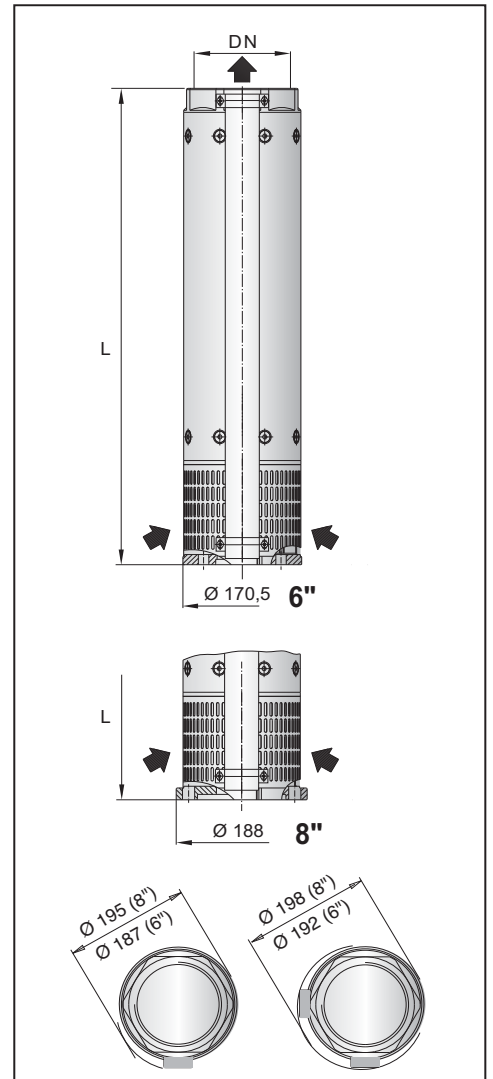
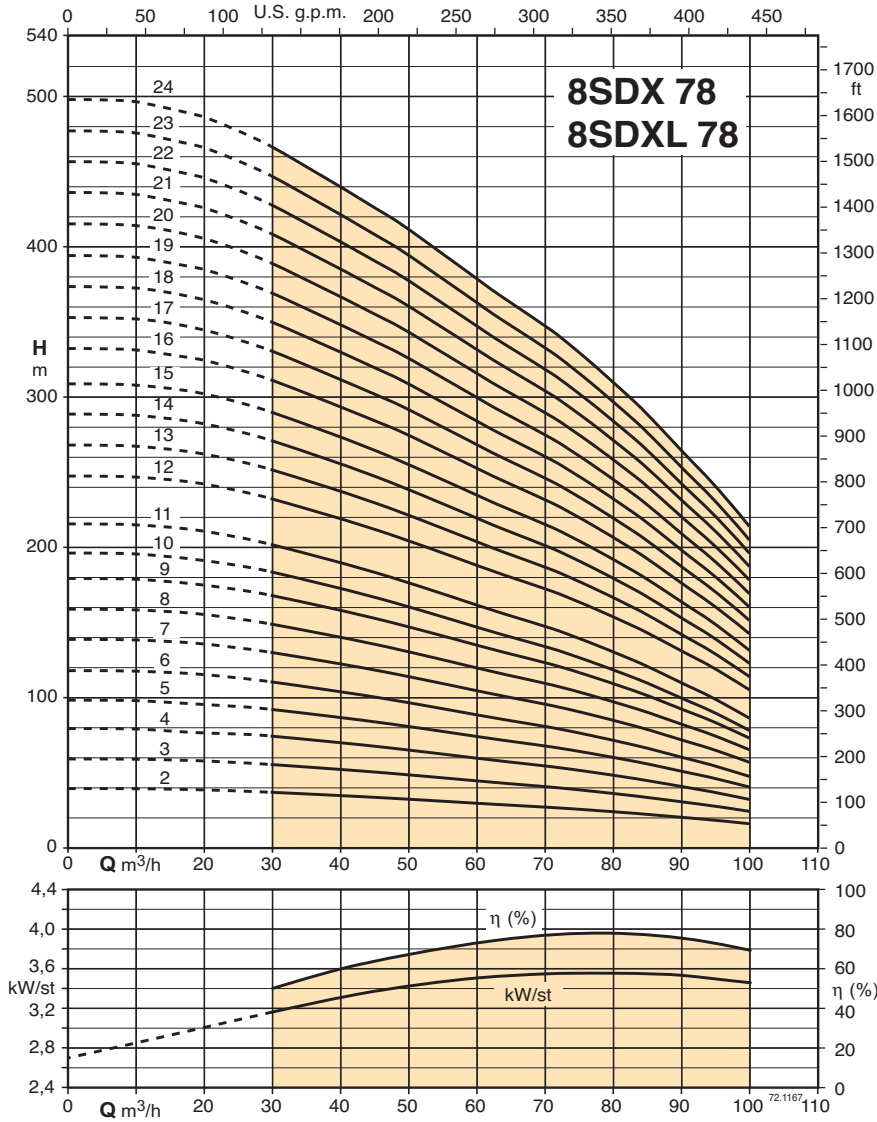

| 3 ~                      | P <sub>2</sub> |          | Q      | n ≈ 2900 1/min |      |       |      |      |      |      |      |      |     | DN        | Moteur    |      |      |   |       |    |
|--------------------------|----------------|----------|--------|----------------|------|-------|------|------|------|------|------|------|-----|-----------|-----------|------|------|---|-------|----|
|                          | kW             | HP       |        | m³/h           |      | 1/min |      |      |      |      |      |      |     |           |           | CS   | FK   | L | 8SDXL |    |
|                          |                |          |        | l/min          | 0    | 30    | 40   | 50   | 60   | 70   | 80   | 90   | 100 |           | mm        |      |      |   |       | mm |
| 8SDX 78/2 - 8SDXL 78/2   | 7,5            | 10       | H<br>m | 39,9           | 37,1 | 34,9  | 32,6 | 29,7 | 27,1 | 24,3 | 20,4 | 16,3 |     | 145<br>6" | 137<br>6" | 644  | 31,5 |   |       |    |
| 8SDX 78/3 - 8SDXL 78/3   | 11             | 15       |        | 59,8           | 55,7 | 52,3  | 48,9 | 44,6 | 40,7 | 36,4 | 30,6 | 24,4 |     |           |           | 770  | 36,5 |   |       |    |
| 8SDX 78/4 - 8SDXL 78/4   | 15             | 20       |        | 79,7           | 74,3 | 69,7  | 65,1 | 59,4 | 54,3 | 48,6 | 40,9 | 32,6 |     |           |           | 896  | 41,5 |   |       |    |
| 8SDX 78/5 - 8SDXL 78/5   | 18,5           | 25       |        | 99,6           | 92,9 | 87,1  | 81,4 | 74,3 | 67,9 | 60,7 | 51,1 | 40,7 |     |           |           | 1022 | 46,5 |   |       |    |
| 8SDX 78/6 - 8SDXL 78/6   | 22             | 30       |        | 120            | 111  | 105   | 97,7 | 89,1 | 81,4 | 72,9 | 61,3 | 48,9 |     |           |           | 1148 | 51   |   |       |    |
| 8SDX 78/7 - 8SDXL 78/7   | 26 (30)        | 35 (40)  |        | 140            | 130  | 122   | 114  | 104  | 95   | 85   | 71,5 | 57   |     |           |           | 1274 | 56   |   |       |    |
| 8SDX 78/8 - 8SDXL 78/8   | 30             | 40       |        | 156            | 146  | 138   | 128  | 117  | 107  | 94,5 | 80   | 63,3 |     |           |           | 1400 | 61   |   |       |    |
| 8SDX 78/9 - 8SDXL 78/9   | 30             | 40       |        | 176            | 164  | 155   | 144  | 132  | 120  | 106  | 90   | 71,2 |     |           |           | 1526 | 66   |   |       |    |
| 8SDX 78/10 - 8SDXL 78/10 | 37             | 50       |        | 195            | 183  | 173   | 160  | 147  | 134  | 118  | 100  | 79,1 |     |           |           | 1652 | 71   |   |       |    |
| 8SDX 78/11 - 8SDXL 78/11 | 37             | 50       |        | 215            | 201  | 190   | 176  | 162  | 147  | 130  | 110  | 87   |     |           |           | 1778 | 76   |   |       |    |
| 8SDX 78/12 - 8SDXL 78/12 | 45             | 60       |        | 248            | 232  | 218   | 203  | 187  | 171  | 154  | 130  | 105  |     |           |           | 1909 | 82   |   |       |    |
| 8SDX 78/13 - 8SDXL 78/13 | 51 (55)        | 70 (75)  |        | 268            | 251  | 237   | 220  | 203  | 185  | 166  | 141  | 114  |     |           |           | 2035 | 87   |   |       |    |
| 8SDX 78/14 - 8SDXL 78/14 | 51 (55)        | 70 (75)  |        | 289            | 271  | 255   | 237  | 218  | 200  | 179  | 152  | 122  |     | 2161      | 92        |      |      |   |       |    |
| 8SDX 78/15 - 8SDXL 78/15 | 55             | 75       |        | 310            | 290  | 273   | 254  | 234  | 214  | 192  | 163  | 131  |     | 2287      | 97        |      |      |   |       |    |
| 8SDX 78/16 - 8SDXL 78/16 | 59 (75)        | 80 (100) |        | 332            | 312  | 293   | 274  | 252  | 232  | 206  | 176  | 143  |     | 2413      | 101,5     |      |      |   |       |    |
| 8SDX 78/17 - 8SDXL 78/17 | 66 (75)        | 90 (100) |        | 353            | 332  | 311   | 292  | 268  | 247  | 219  | 187  | 152  |     | 2539      | 106,5     |      |      |   |       |    |
| 8SDX 78/18 - 8SDXL 78/18 | 66 (75)        | 90 (100) |        | 374            | 351  | 329   | 309  | 284  | 261  | 232  | 198  | 161  |     | 2665      | 111,5     |      |      |   |       |    |
| 8SDX 78/19 - 8SDXL 78/19 | 75             | 100      |        | 394            | 371  | 348   | 326  | 299  | 276  | 245  | 209  | 170  |     | 2791      | 116,5     |      |      |   |       |    |
| 8SDX 78/20 - 8SDXL 78/20 | 75             | 100      |        | 415            | 390  | 366   | 343  | 315  | 290  | 258  | 220  | 179  |     | 2917      | 121       |      |      |   |       |    |
| 8SDX 78/21 - 8SDXL 78/21 | 75             | 100      |        | 436            | 409  | 385   | 361  | 331  | 304  | 271  | 231  | 187  |     | 3043      | 126       |      |      |   |       |    |
| 8SDX 78/22 - 8SDXL 78/22 | 92             | 125      |        | 457            | 428  | 403   | 378  | 347  | 318  | 284  | 242  | 196  |     | 3169      | 131       |      |      |   |       |    |
| 8SDX 78/23 - 8SDXL 78/23 | 92             | 125      |        | 478            | 448  | 422   | 395  | 363  | 333  | 297  | 253  | 205  |     | 3295      | 136       |      |      |   |       |    |
| 8SDX 78/24 - 8SDXL 78/24 | 92             | 125      |        | 499            | 467  | 440   | 412  | 379  | 347  | 310  | 264  | 214  |     | 3421      | 141       |      |      |   |       |    |

P<sub>2</sub> Puissance nominale du moteur

(...) Puissance nominale du moteur FK

H Hauteur totale en m

Tolérances suivant ISO 9906-A

# 8SDX 97

Pompes immergées pour puits de 8"



## Courbes caractéristiques et performances n ≈ 2900 1/min, dimensions et poids

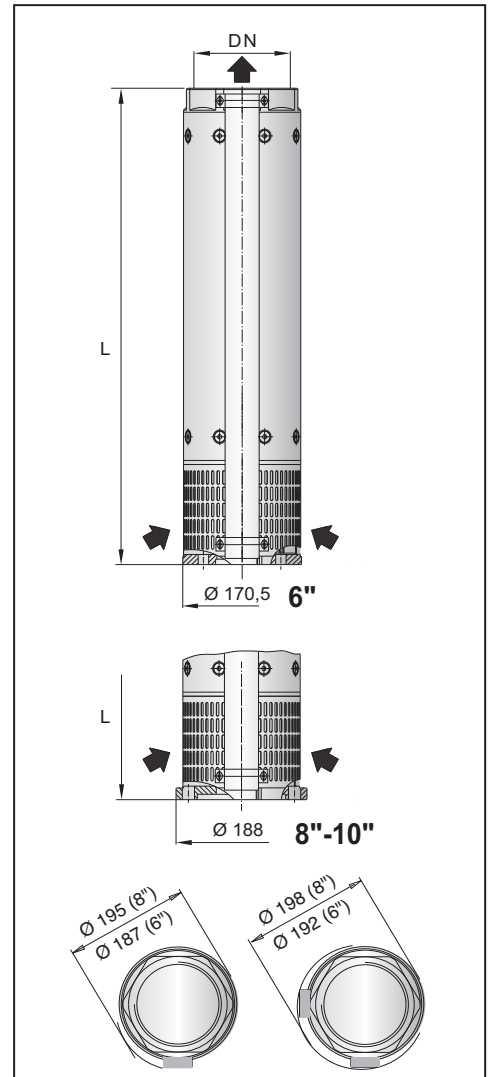
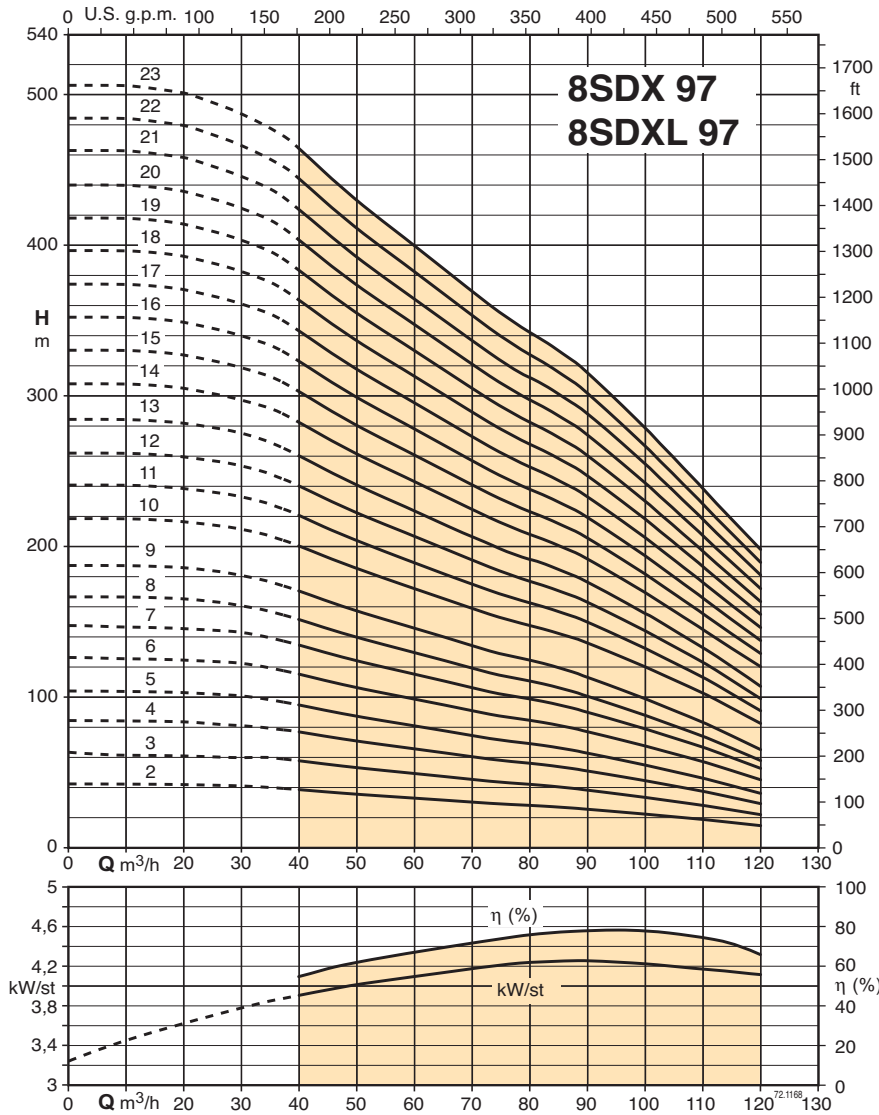

| 3 ~                      | P <sub>2</sub> |           | Q      | n ≈ 2900 1/min |      |      |      |      |      |      |      |      |      |  |  |  |
|--------------------------|----------------|-----------|--------|----------------|------|------|------|------|------|------|------|------|------|--|--|--|
|                          | kW             | HP        |        | m³/h           |      |      |      |      |      |      |      |      |      |  |  |  |
|                          |                |           |        | 0              | 40   | 50   | 60   | 70   | 80   | 90   | 100  | 110  | 120  |  |  |  |
| 8SDX 97/2 - 8SDXL 97/2   | 9,2            | 12,5      | H<br>m | 41,2           | 38,6 | 35,2 | 32,2 | 29,8 | 27,8 | 24,8 | 21,8 | 18,6 | 14,8 |  |  |  |
| 8SDX 97/3 - 8SDXL 97/3   | 13 (15)        | 17,5 (20) |        | 61,8           | 57,9 | 52,8 | 48,3 | 44,7 | 41,7 | 37,2 | 32,7 | 27,9 | 22,2 |  |  |  |
| 8SDX 97/4 - 8SDXL 97/4   | 18,5           | 25        |        | 82,4           | 77,2 | 70,4 | 64,4 | 59,6 | 55,6 | 49,6 | 43,6 | 37,2 | 29,6 |  |  |  |
| 8SDX 97/5 - 8SDXL 97/5   | 22             | 30        |        | 103            | 96,5 | 88   | 80,5 | 74,5 | 69,5 | 62   | 54,5 | 46,5 | 37   |  |  |  |
| 8SDX 97/6 - 8SDXL 97/6   | 26 (30)        | 35 (40)   |        | 125            | 113  | 105  | 96,7 | 89   | 82,7 | 75   | 66,3 | 55   | 44   |  |  |  |
| 8SDX 97/7 - 8SDXL 97/7   | 30             | 40        |        | 146            | 132  | 123  | 113  | 104  | 96,4 | 87,5 | 77,4 | 64,2 | 51,3 |  |  |  |
| 8SDX 97/8 - 8SDXL 97/8   | 37             | 50        |        | 167            | 151  | 140  | 129  | 119  | 110  | 100  | 88,4 | 73,3 | 58,7 |  |  |  |
| 8SDX 97/9 - 8SDXL 97/9   | 37             | 50        |        | 188            | 170  | 158  | 145  | 134  | 124  | 113  | 99,5 | 82,5 | 66   |  |  |  |
| 8SDX 97/10 - 8SDXL 97/10 | 45             | 60        |        | 219            | 200  | 185  | 172  | 158  | 147  | 135  | 119  | 102  | 83,1 |  |  |  |
| 8SDX 97/11 - 8SDXL 97/11 | 51 (55)        | 70 (75)   |        | 241            | 220  | 204  | 189  | 174  | 162  | 149  | 131  | 112  | 91,4 |  |  |  |
| 8SDX 97/12 - 8SDXL 97/12 | 51 (55)        | 70 (75)   |        | 263            | 240  | 222  | 206  | 190  | 176  | 162  | 143  | 122  | 99,7 |  |  |  |
| 8SDX 97/13 - 8SDXL 97/13 | 55             | 75        |        | 285            | 260  | 241  | 223  | 206  | 191  | 176  | 155  | 132  | 108  |  |  |  |
| 8SDX 97/14 - 8SDXL 97/14 | 59 (75)        | 80 (100)  |        | 309            | 281  | 262  | 242  | 224  | 208  | 191  | 169  | 144  | 120  |  |  |  |
| 8SDX 97/15 - 8SDXL 97/15 | 66 (75)        | 90 (100)  |        | 331            | 302  | 279  | 261  | 240  | 222  | 205  | 182  | 156  | 129  |  |  |  |
| 8SDX 97/16 - 8SDXL 97/16 | 75             | 100       |        | 353            | 322  | 298  | 278  | 256  | 237  | 219  | 194  | 166  | 138  |  |  |  |
| 8SDX 97/17 - 8SDXL 97/17 | 75             | 100       |        | 375            | 342  | 317  | 295  | 272  | 251  | 233  | 206  | 176  | 147  |  |  |  |
| 8SDX 97/18 - 8SDXL 97/18 | 92             | 125       |        | 397            | 362  | 335  | 313  | 288  | 266  | 246  | 218  | 187  | 155  |  |  |  |
| 8SDX 97/19 - 8SDXL 97/19 | 92             | 125       |        | 419            | 382  | 354  | 330  | 304  | 281  | 260  | 230  | 197  | 164  |  |  |  |
| 8SDX 97/20 - 8SDXL 97/20 | 92             | 125       |        | 440            | 403  | 374  | 348  | 322  | 298  | 274  | 244  | 209  | 173  |  |  |  |
| 8SDX 97/21 - 8SDXL 97/21 | 92             | 125       |        | 462            | 424  | 393  | 365  | 338  | 313  | 288  | 257  | 219  | 182  |  |  |  |
| 8SDX 97/22 - 8SDXL 97/22 | 110            | 150       |        | 484            | 444  | 411  | 383  | 354  | 328  | 301  | 269  | 230  | 190  |  |  |  |
| 8SDX 97/23 - 8SDXL 97/23 | 110            | 150       |        | 507            | 464  | 430  | 400  | 370  | 343  | 315  | 281  | 240  | 199  |  |  |  |

| DN         | Moteur    |           |         |             |
|------------|-----------|-----------|---------|-------------|
|            | CS<br>mm  | FK<br>mm  | L<br>mm | 8SDXL<br>kg |
| Rp<br>5"   | 145<br>6" | 137<br>6" | 644     | 31,5        |
|            |           |           | 770     | 36,5        |
|            |           |           | 896     | 41,5        |
|            |           |           | 1022    | 46          |
|            |           |           | 1148    | 51          |
|            | 191<br>8" | 196<br>8" | 1274    | 56          |
|            |           |           | 1400    | 61          |
|            |           |           | 1526    | 66          |
|            |           |           | 1657    | 72          |
|            |           |           | 1783    | 77          |
| 240<br>10" |           | 1909      | 82      |             |
|            |           | 2035      | 87      |             |
|            |           | 2161      | 92      |             |
|            |           | 2287      | 97      |             |
|            |           | 2413      | 102     |             |
|            |           |           | 2539    | 106,5       |
|            |           |           | 2665    | 111,5       |
|            |           |           | 2791    | 116,5       |
|            |           |           | 2917    | 121         |
|            |           |           | 3043    | 126         |
|            |           |           | 3169    | 131         |
|            |           |           | 3295    | 136         |